



# LockNLoad™ Track Mounting Kit

LAND ROVER DISCOVERY 3 & 4  
TRACK MOUNT HEAVY DUTY ROOF RACK SYSTEM

**MAX VEHICLE ROOF LOAD RATING\*: 75KG**

**TOTAL LOAD EQUALS WEIGHT OF ROOF RACKS + ACCESSORIES + CARGO**

\*Manufacturer's Rated Maximum \*Not suitable for vehicle fitted with panoramic glass roof

## FIRST TIME INSTALLATION

- Please read instructions carefully before installation.
- Check the contents of kit. Contact your YAKIMA dealer if any parts appear missing or damaged.
- Clean your roof thoroughly prior to fitting the LockNLoad Track Heavy Duty Roof Rack System.
- Place these instructions in the vehicle's glove box after installation is complete.



### TOOLS REQUIRED:

- Pencil
- Rivet Gun
- Centre Punch
- Hammer
- Drill Stop
- Tape Measure
- Vacuum Cleaner
- 4 mm Allen Key
- Double Sided Tape
- #2 Phillips Head Screwdriver
- Zinc Rich Cold Galvanising Coating
- Power or Cordless Drill
- Flat Blade Screwdriver
- 10 mm Open Ended Spanner
- 13 mm Socket or Spanner
- Torque Wrench (Optional)
- Mastic Silicone Sealant
- Fine Tooth Hacksaw
- Rubber Mallet (Optional)

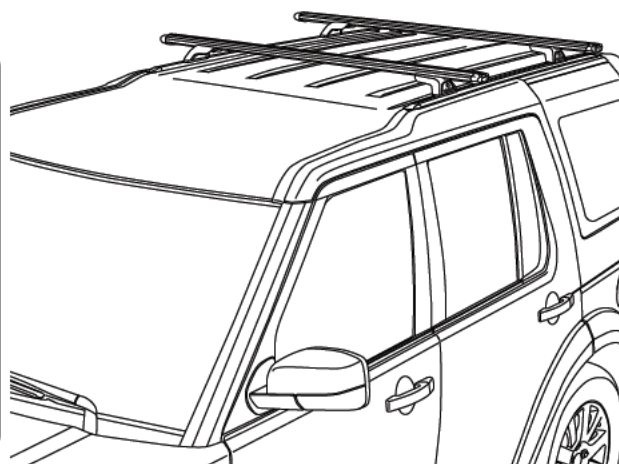

## KIT CONTENTS

| ITEM | COMPONENT                           | QTY | ITEM | COMPONENT                         | QTY |
|------|-------------------------------------|-----|------|-----------------------------------|-----|
| 1.   | Track Rear Land Rover Disco 3&4 RHS | x1  | 8.   | Rivet 22 mm                       | x2  |
| 2.   | Track Rear Land Rover Disco 3&4 LHS | x1  | 9.   | End Cap Front Left & Rear Right   | x2  |
| 3.   | Track Nut Plate                     | x4  | 10.  | End Cap Front Right & Rear Left   | x2  |
| 4.   | M6 Washer                           | x14 | 11.  | Mounting Boss                     | x2  |
| 5.   | M6 Spring Washer                    | x12 | 12.  | Button Head Capscrew with Loctite | x2  |
| 6.   | M6 Hex Screw                        | x8  | 13.  | Drill Bit 4.9 mm                  | x1  |
| 7.   | M6 Button Head Capscrew             | x4  |      |                                   |     |



### LEG AND BAR COMPONENTS SOLD SEPARATELY

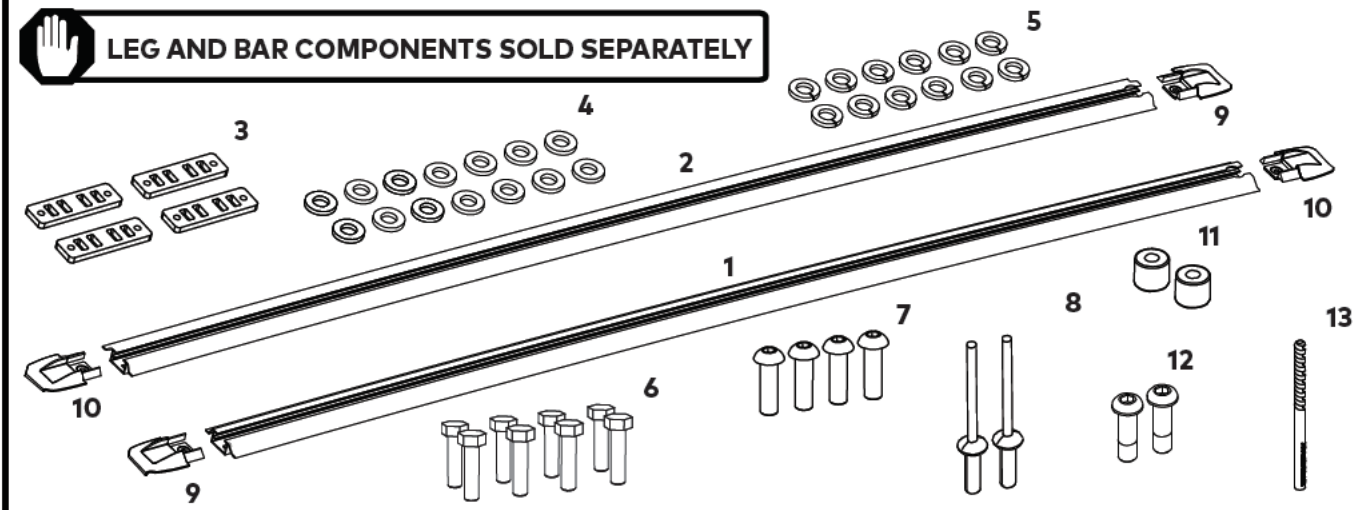

# TRACK INSTALLATION

## BEFORE BEGINNING INSTALLATION

Clean roof thoroughly and allow to dry before beginning installation.

**It is recommended to install one Track at a time.**

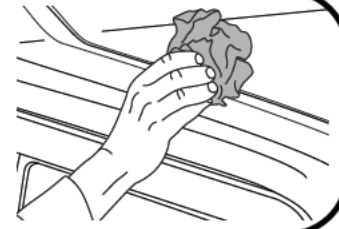

## 1 MEASURE REAR ROOF CHANNEL TRIM

Using a Tape Measure, measure 1530 mm forward from the edge of the rear roof channel trim as shown

Record measurement lines on trim with a pencil at 1530 mm and another at 100 mm.

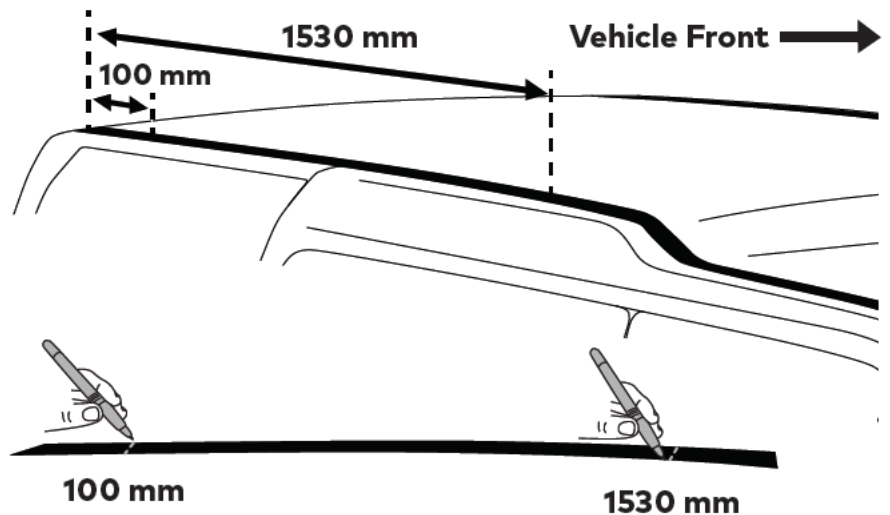

## 2 REMOVE ROOF CHANNEL TRIM

Lift rubber roof trim up and outwards at rear of vehicle using fingers. Gently twist trim to unhook plastic clips. Do not use excessive force as the clips could break.

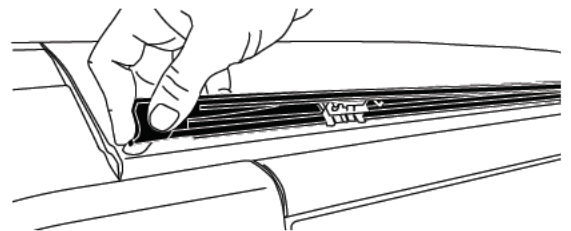

## 3 CUT ROOF CHANNEL TRIM

Away from vehicle, cut trim along marked lines recorded in Step 1 using a Fine Tooth Hacksaw.

Store aside one of the white plastic clips from middle cut section of trim for later use in Step 13.

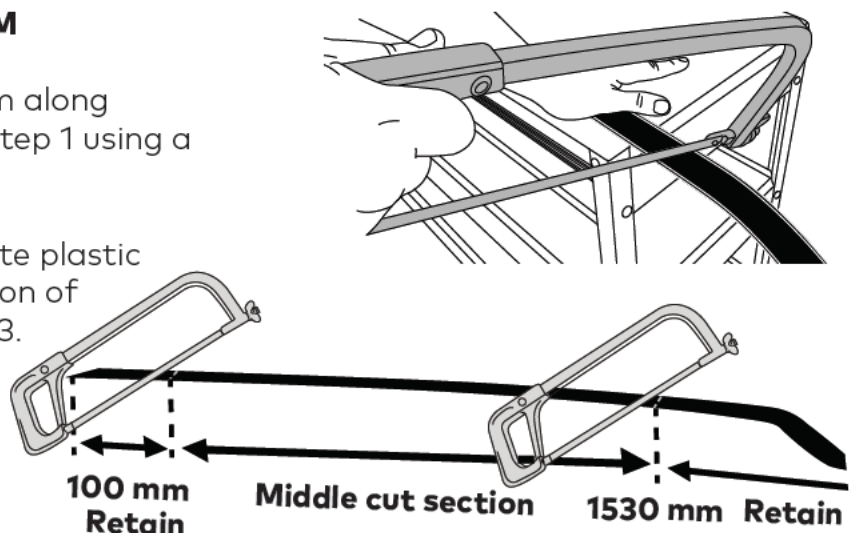
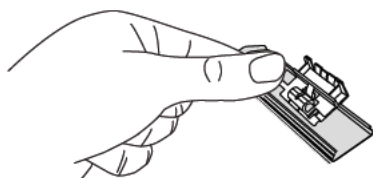

# 4

## REMOVE PLUGS

Using a Flat Blade Screwdriver (wrap tape around end of Screwdriver to prevent paint scratching if you should slip), lever out the 3 plastic plugs in each side of roof channel to expose nutserts.

**Do not remove the nutserts.**

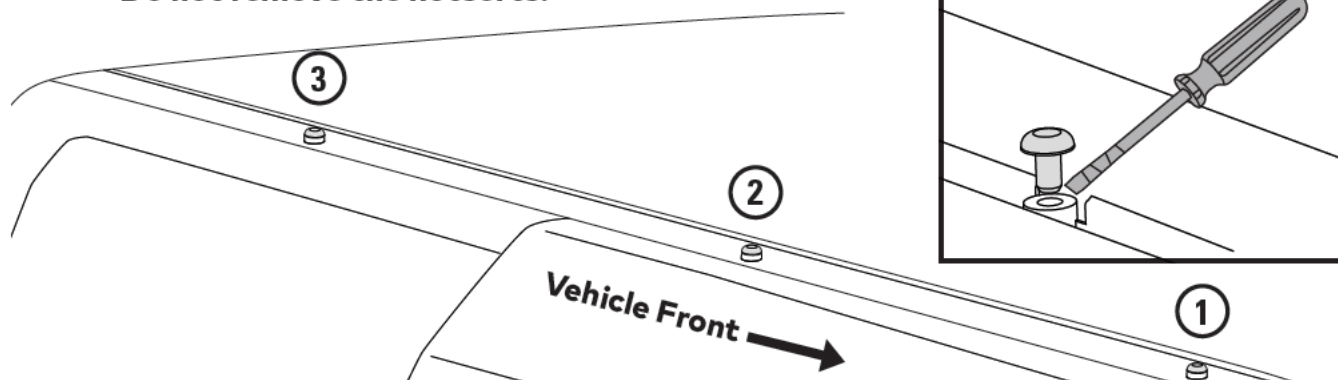

# 5

## TRACK ORIENTATION

The **longest** side flange faces **outside** of vehicle as shown.

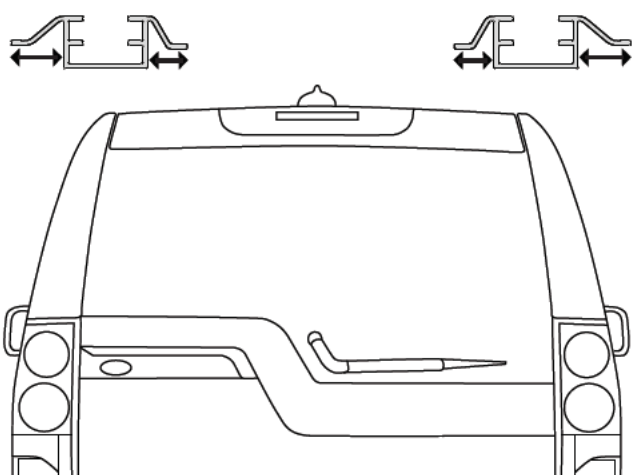

# 6

## PLACE TRACK

Taking note of the Track orientation shown in the previous Step, fasten the Track to nutsert ① in roof channel via the **front track hole** using 1 x M6 Button Head Capscrew. Finger tighten screw.

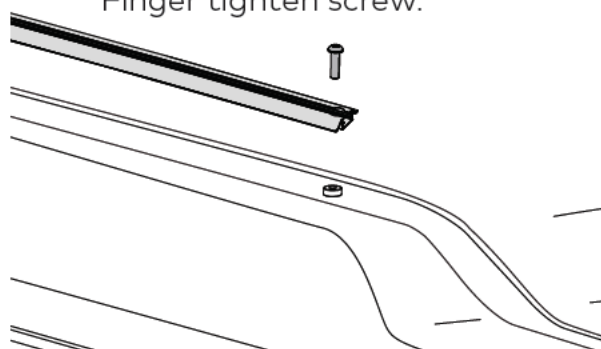

# 7

## CENTRE PUNCH REAR RIVET POSITION

With the Track in place, use a Centre Punch to gently mark the rear rivet position.

Remove Track.

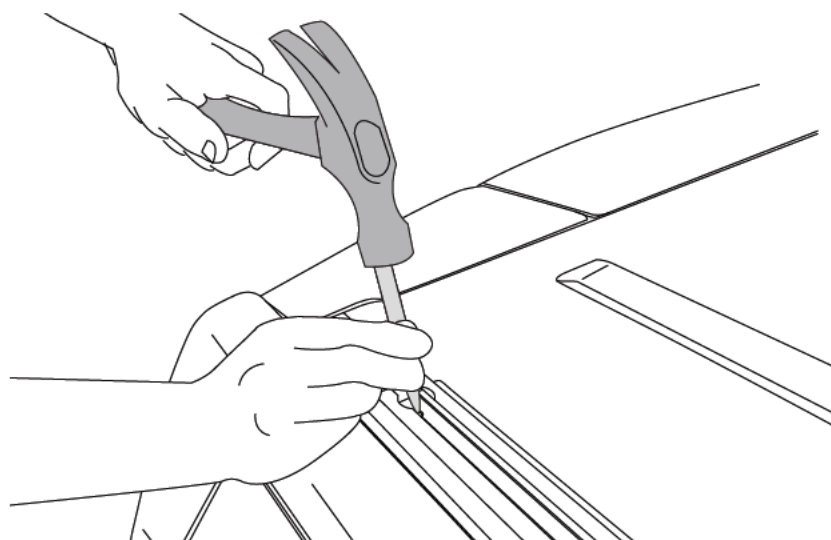

## 8 REVEAL REAR RIVET FIXING POINT

The rear rivet fixing point is covered with sealant. Use a sharp tool to scrape away enough seal so that Mounting Boss can seat correctly.

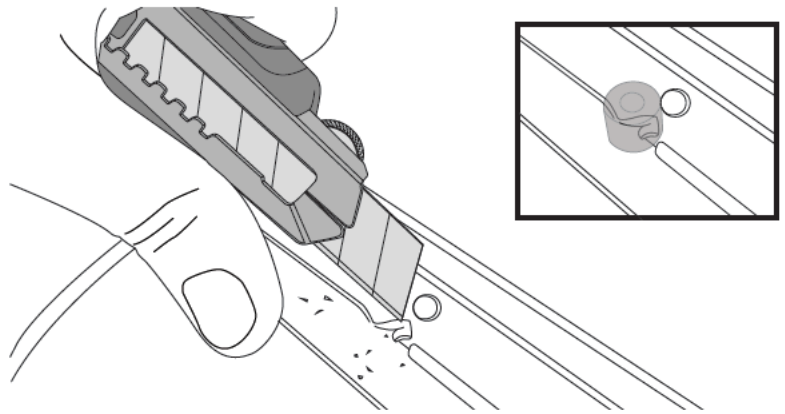

## 9 DRILL ROOF

Using supplied 4.9 mm Drill Bit and a Drill Stop, carefully drill through the roof channel at the marked location. **Only drill enough to just break through roof skin.** Ensure a drilling angle perpendicular to the roof surface is maintained throughout.

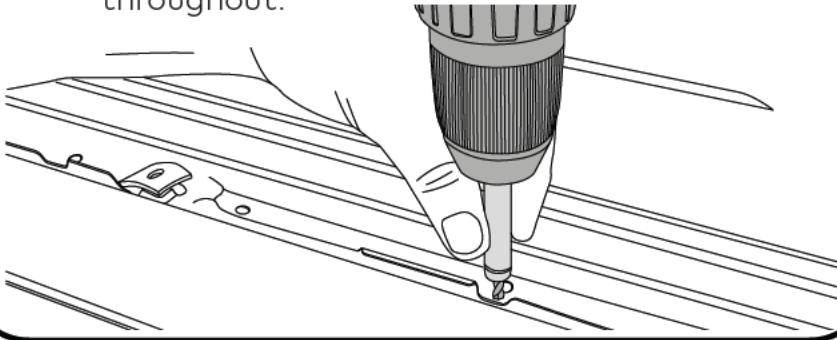

## 10 REMOVE SWARF

Avoid scratching and pushing swarf into the newly drilled hole by removing swarf from roof channel with a Vacuum Cleaner.

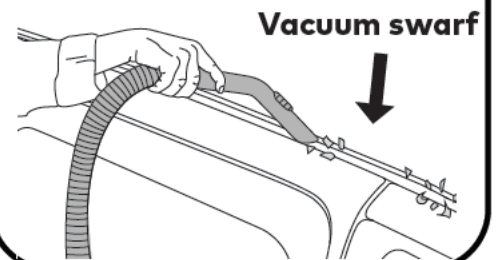

## 11 APPLY PROTECTIVE SEALANTS

### Stage 1

Liberal apply a Zinc Rich Cold Galvanising Solution to the inside surface and surrounds of the drilled hole. Allow solution to become touch dry before proceeding with Stage 2 (approx. 10 min depending on product used).

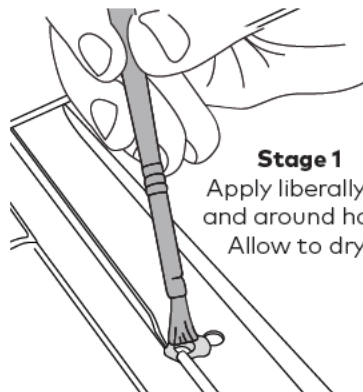

### Stage 1

Apply liberally in and around hole. Allow to dry.

### Stage 2

Liberal apply a Mastic Silicone Sealant to the inside surface and surrounds of hole.

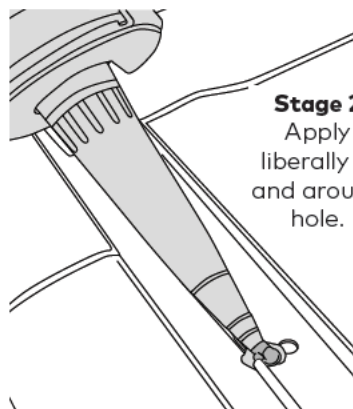

### Stage 2

Apply liberally in and around hole.

## 12 POSITION MOUNTING BOSS

While Mastic Silicone Sealant is still wet, position Mounting Boss on top of seal over drilled hole as shown.

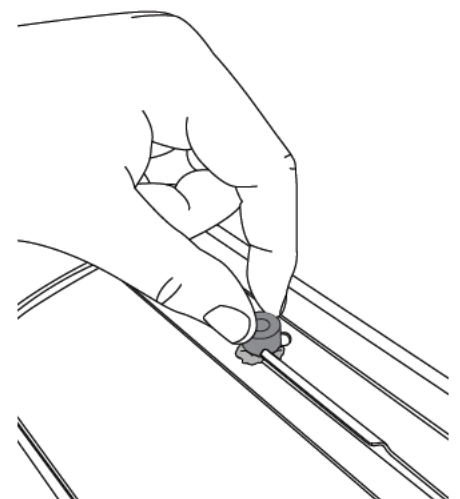



### 13 ATTACH PLASTIC CLIP TO REAR SMALL TRIM

Apply Double Sided Tape to the underside of small rear trim piece cut in Step 3, and to the fin of roof channel as pictured.

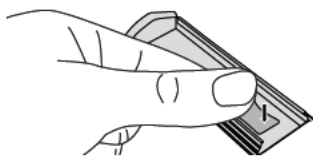

Attach one of the white plastic roof trim clips removed in Step 3 to the Doubled Sided Tape on underside of trim as shown.

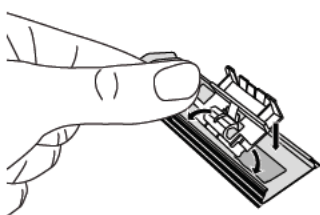
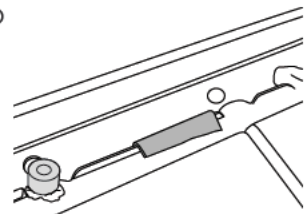

### 14 REFIT ROOF TRIM

Return the two pieces of trim cut in Step 3 back into roof channel as shown.

Ensure trim is hooked back onto the roof channel via the plastic clips.

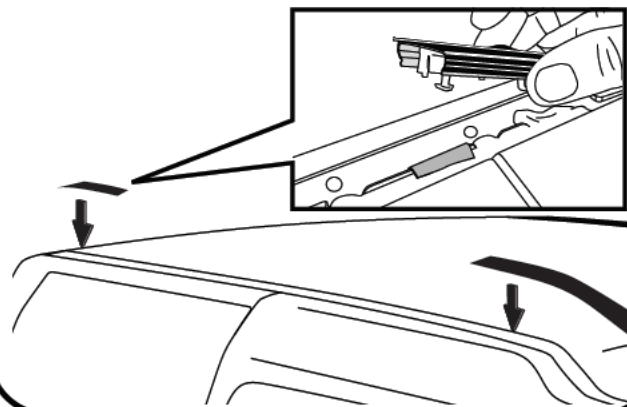

### 15 CONNECT END CAPS

Insert End Caps into both Track ends.

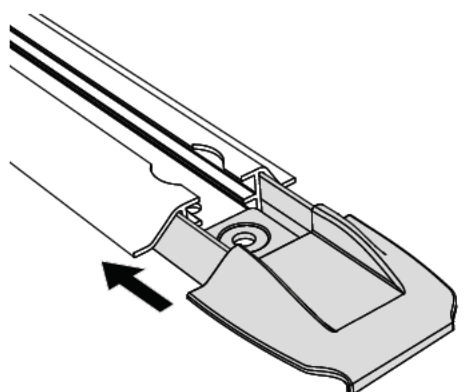

x2

### 16 SECURE FRONT END CAP

Taking note of the Track orientation shown in Step 5, fasten the Track to the front nutsert in roof channel through the front facing End Cap hole using 1 x M6 Washer and 1 x M6 Button Head Capscrew. Finger tighten screw.

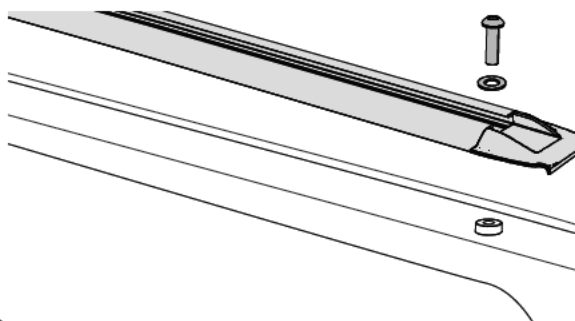

### 17 ALIGN AND SECURE TRACK IN ROOF CHANNEL

Align Track in roof channel by inserting the two remaining M6 Washer and Button Head Capscrew assemblies into the middle hole and then the rear hole as shown.

Tighten all **three** Capscrews to 4 Nm using a 4 mm Allen Key or a suitable Torque Wrench.

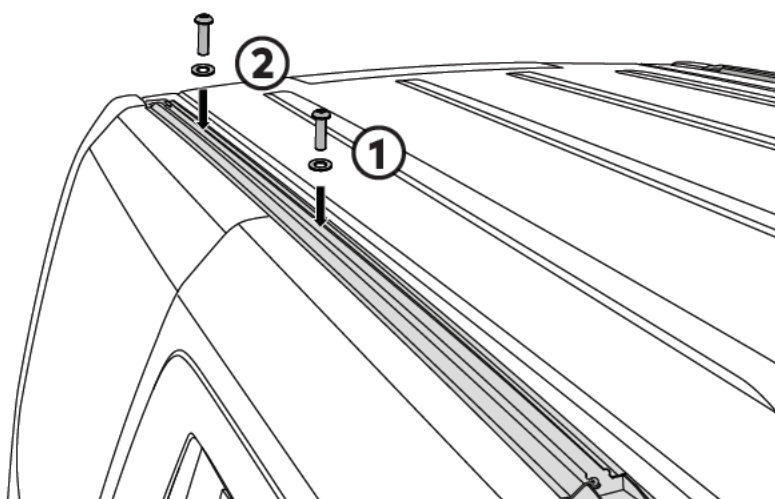

**18****RIVET REAR OF TRACK AND END CAP**

Align rear of Track by inserting a Rivet through End Cap and Track into the previously drilled hole. Secure using a Rivet Gun.

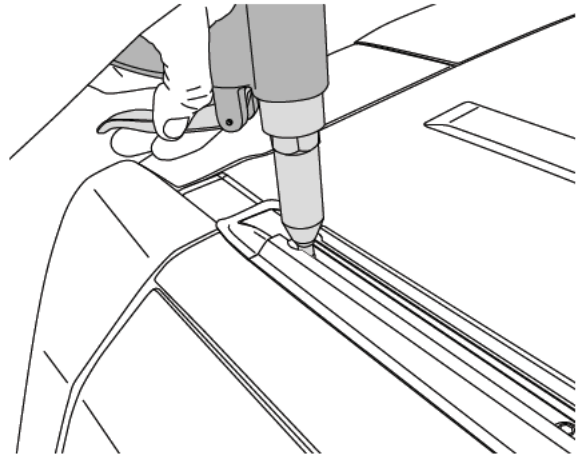
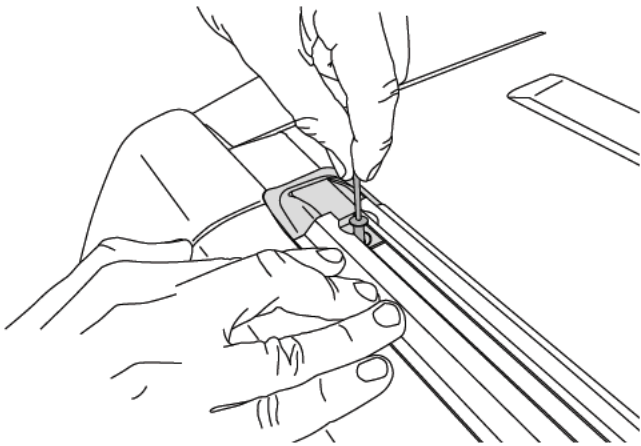
**19****TRACK INSTALLATION COMPLETE**

Check both Tracks are secured to the vehicle as per these installation instructions.

For assistance contact your local Yakima dealer.

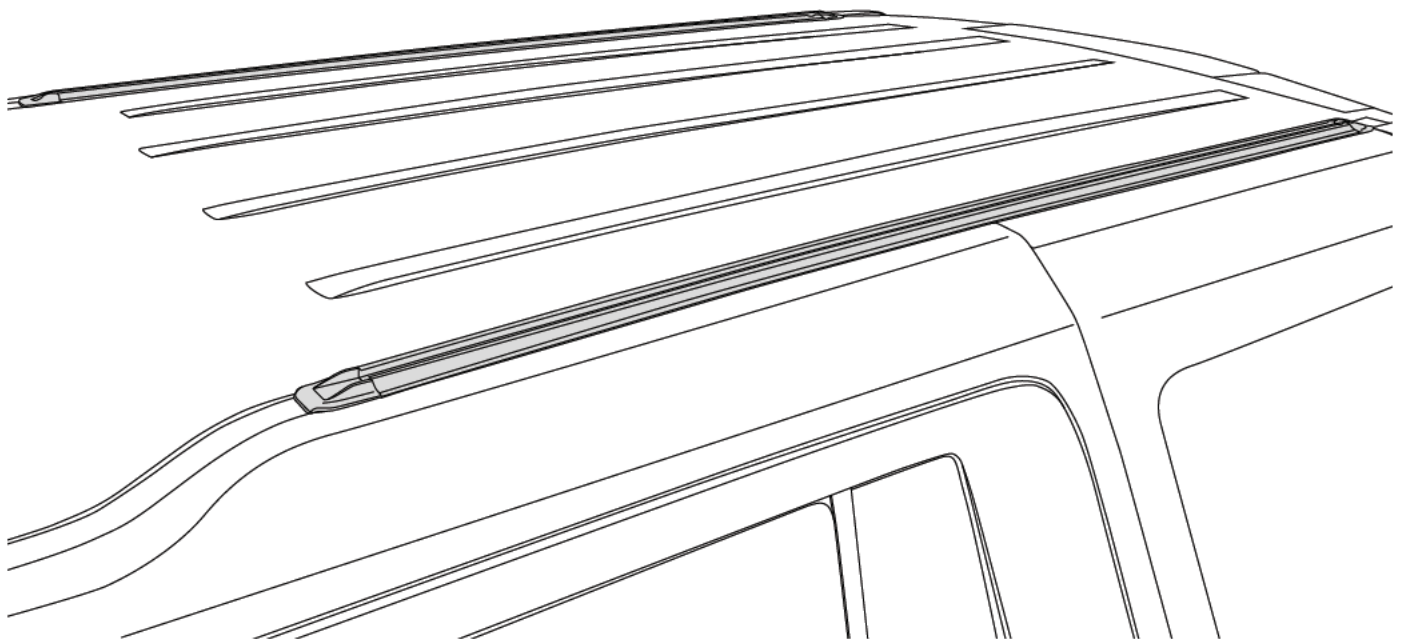

**IF INSTALLING LockNLoad ROOF RACKS, CONTINUE ON PAGE 7**

**IF INSTALLING LockNLoad PLATFORM, NOW SWITCH TO YOUR PLATFORM INSTRUCTIONS**

## BAR INSTALLATION

**1**

### REMOVE END CAPS FROM BARS

From the LockNLoad Bar Kit (sold separately), remove Plastite Screw from each Bar end using a #2 Phillips Head Screwdriver and pull out End Caps from Bars.

Keep all parts aside for later installation.

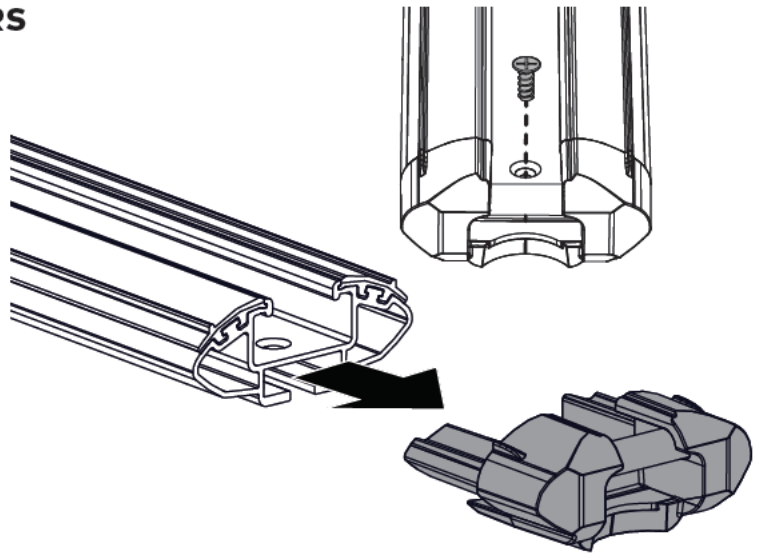

**2**

### REMOVE LEG COVERS

Using the keys supplied in the LockNLoad Leg Kit (sold separately), remove all Leg Covers.

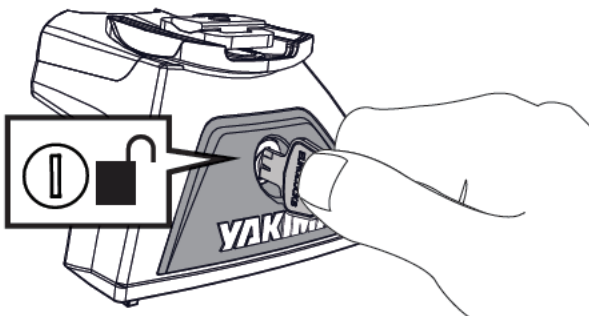

**3**

### INSERT LEGS

Slide the pre-assembled Leg assemblies into the underside channel of LockNLoad Bars.

If Leg assemblies will not slide in, loosen Screws to increase gap.

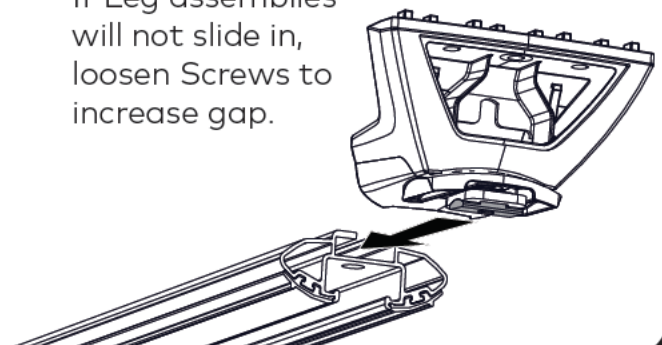

**4**

### INSERT NUT PLATES

Run all M6 Hex Screws through Nut Plates to remove burrs.

Insert one (1) Nut Plate into each Front Track, and two (2) Nut Plates into each Rear Track via the End Caps as shown.

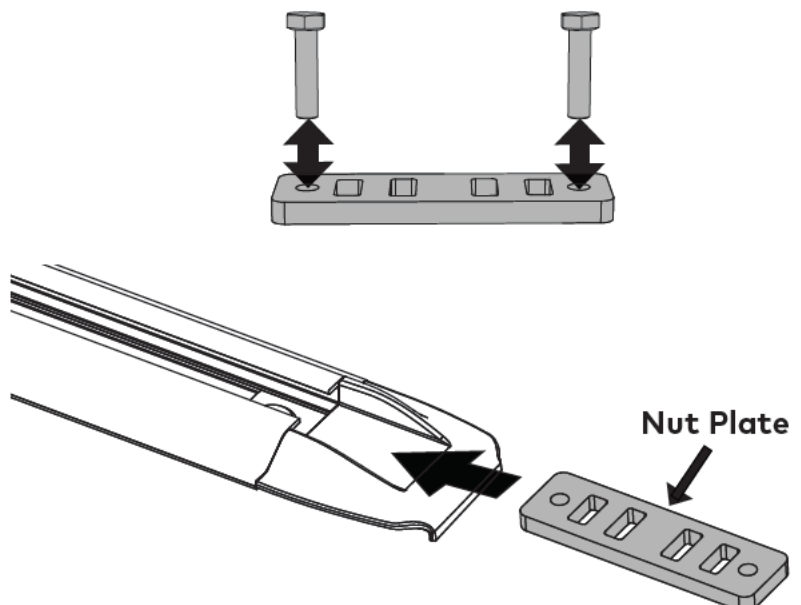

**5****BAR LOCATION**

**IMPORTANT:** Before beginning Bar installation, identify where along the Track you want the Rear Bars fitted.

We recommend a minimum of 700 mm between Bars.

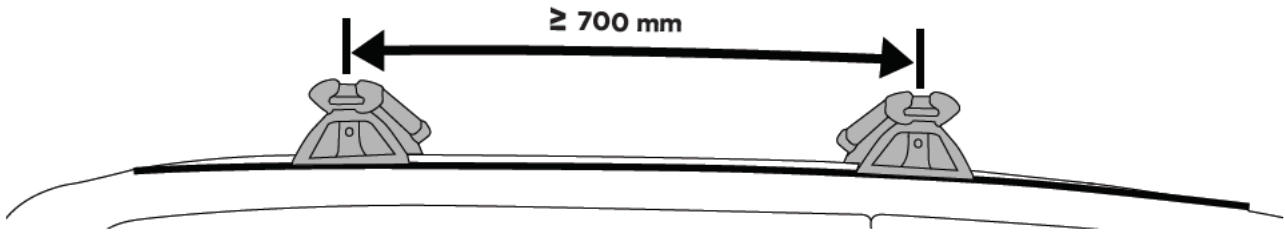
**6****BAR PLACEMENT**

Carefully place front Bar assembly over Nut Plates, ensuring spacing is correct as shown in the previous Step. **Take care not to damage vehicle.** Position Legs along Bar until both legs are securely positioned on Nut Plates within Track.

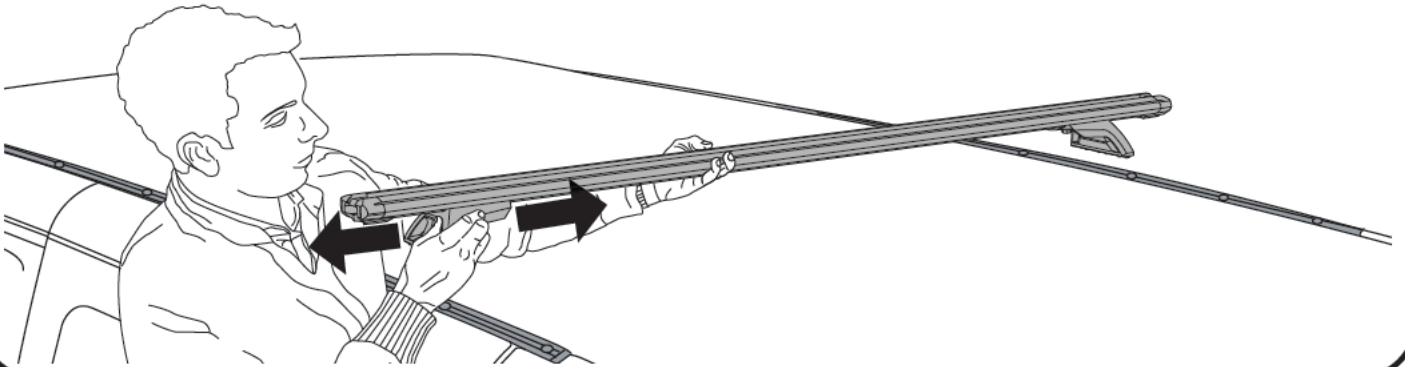
**7****SECURE BAR ASSEMBLY TO TRACKS**

From the LockNLoad Track Kit, insert 1x M6 Hex Screw through the two outer holes on Legs into Nut Plate as shown.

Loosely secure Screws using a 5 mm ball end Allen Key.

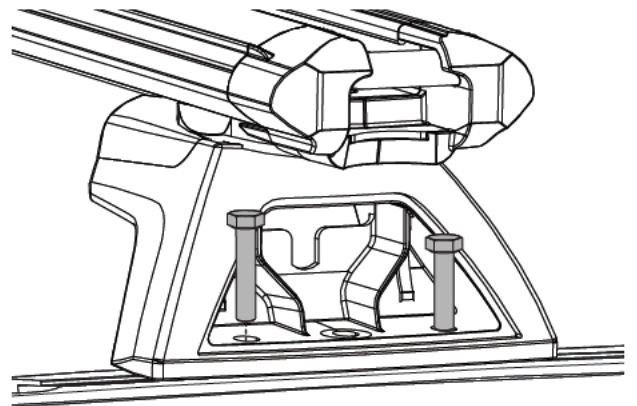
**8****ADJUST BAR OVER HANG**

Use a Tape Measure to ensure even Bar overhang on each side, re-adjust if required by sliding bar along legs.



**NOTE** - Bars require individual adjustment due to tapered roof. Bars must be installed perpendicular to Tracks.



**9**

### SECURE LEGS TO BARS

Tighten all M8 Set Screws to 9 Nm using a 13 mm Spanner.

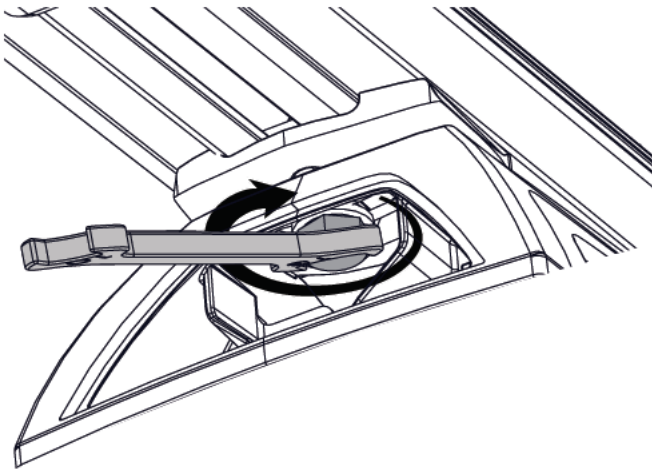

**10**

### REPEAT AND REMOVE

Repeat Steps 6 - 9 for remaining bar assembly.

Carefully remove all Bar and Leg assemblies from vehicle.



**11**

### CHECK BAR SLOT MEASUREMENTS

Place Bars on flat surface with legs facing upwards, as shown. Take appropriate measures to avoid scratching the product and surface.

Identify slot on each Bar end. Using a Tape Measure, record Leg to underside slot distance of each bar in the table (right). Ensure measurement is taken from the centre of the Legs as shown.

| BAR SLOT MEASUREMENTS |
|-----------------------|
| Bar 1 (Y)             |
| _____mm x2            |
| Bar 2 (Z)             |
| _____mm x2            |

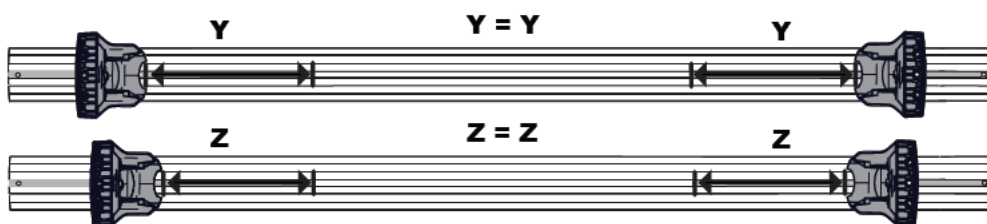

The ends of each bar should be the same measurement respectively, if not, loosen M8 Set Screws and repeat Steps 6-11.

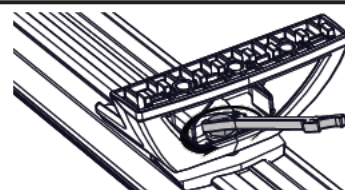

# 12

## BAR SLOT COVERS (INSIDE LEG)

From the LockNLoad Bar Kit, cut Bar Slot Covers as per measurements recorded in the previous Step and press into the underside channel of Bar ends as shown.

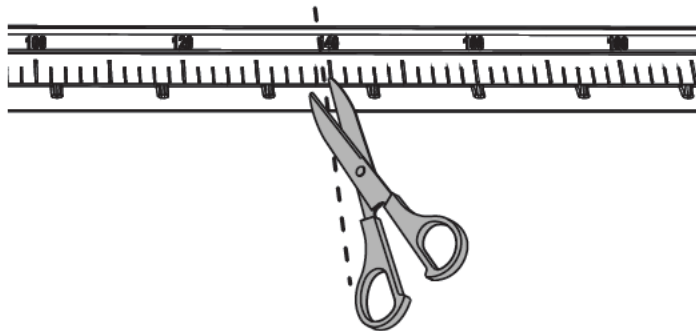

**NOTE** - Bar Slot Covers to be inserted with flat side visible

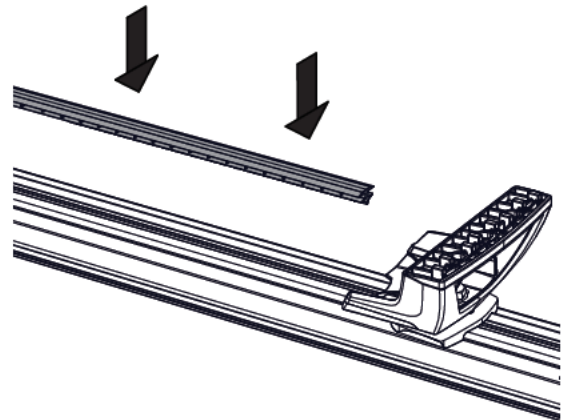

# 13

## BAR SLOT COVERS (OUTSIDE LEG)

Measure the Bar channel outside of the Legs and subtract 20 mm from this measurement.

Using the remaining pieces of Slot Cover from the previous Step, cut to this length and press into the underside channel of each Bar end as shown.

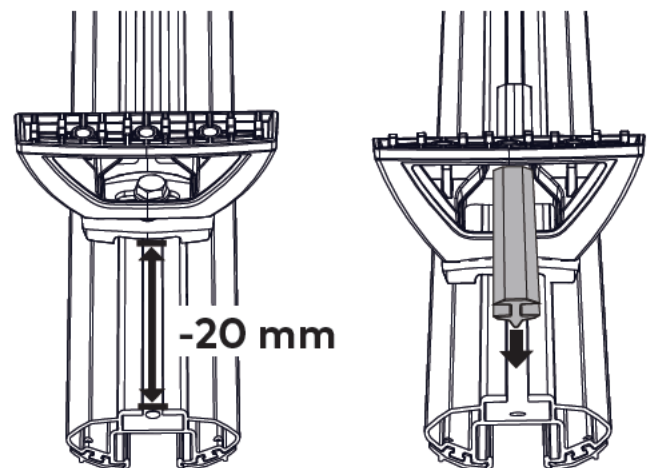

# 14

## SECURE END CAPS TO BARS

Insert the End Caps as shown. A Rubber Mallet can be used to assist installation.

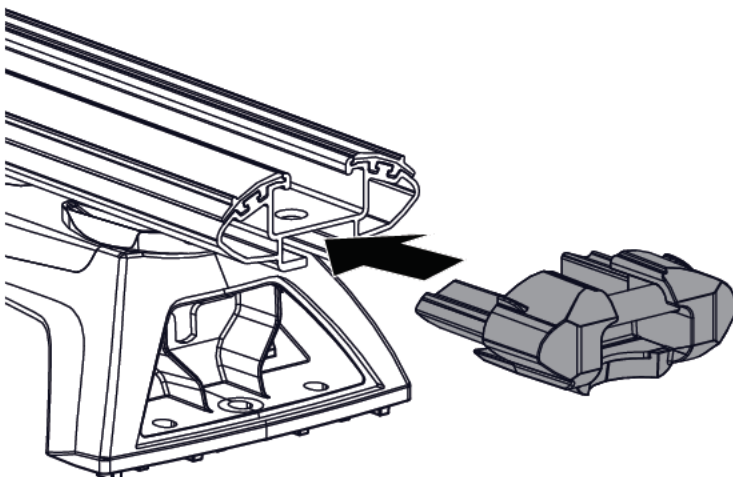

# 15

Secure using Plastite Screw (from LockNLoad Bar Kit). Tighten using a #2 Phillips Head Screwdriver.

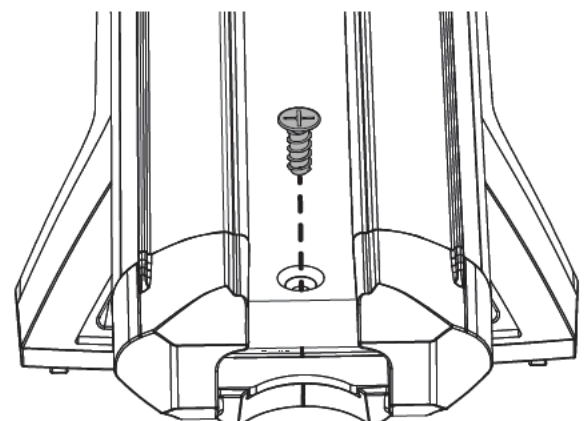

**16****BAR FITMENT**

Slide Nut Plates in Track into position for Bar placement (it doesn't have to be exact). Place Bar assembly onto Tracks, carefully locating the four central raised notches on base of Legs into the cut outs on Nut Plates as shown.

**Take care not to damage vehicle.**

Repeat for remaining Bar.

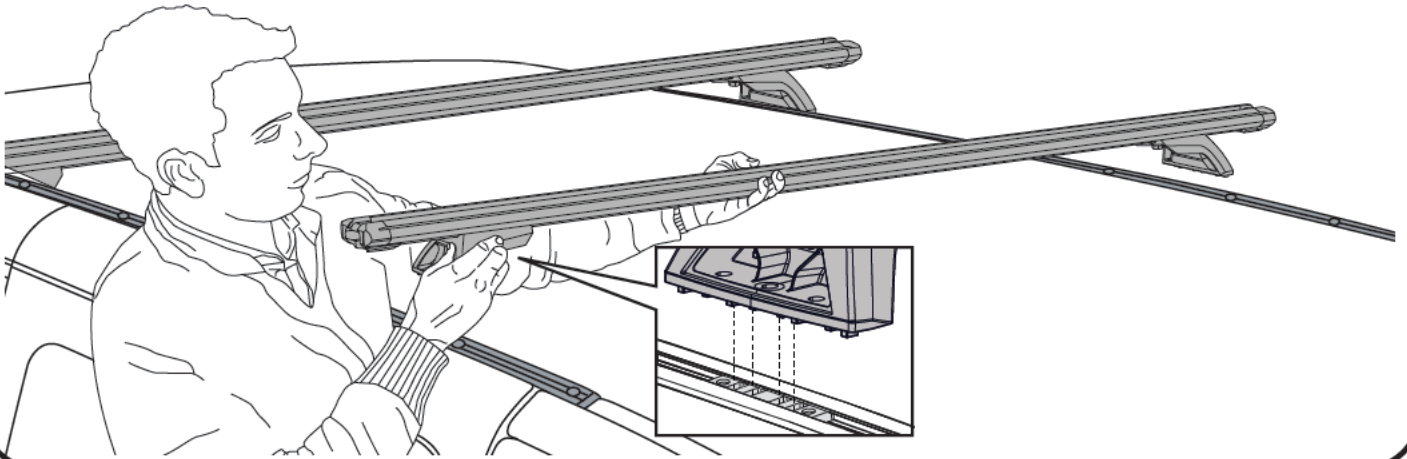
**17**

Position Bars along Tracks as required, ensuring there is a minimum distance of 700 mm between each Bar.

Measure from the centre of each Leg as shown.

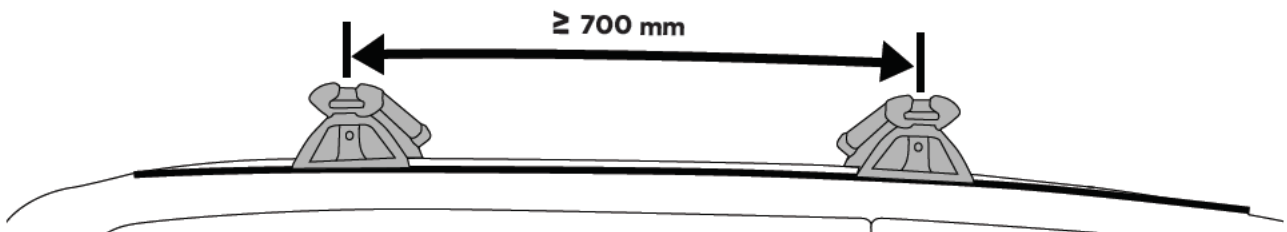
**18****M6 HEX SCREW ASSEMBLY**

From the LockNLoad Track Kit, assemble 1 x M6 Spring Washer and 1 x M6 Washer onto each M6 Hex Screw.

Insert through the outer holes on Legs into Nut Plates as shown.

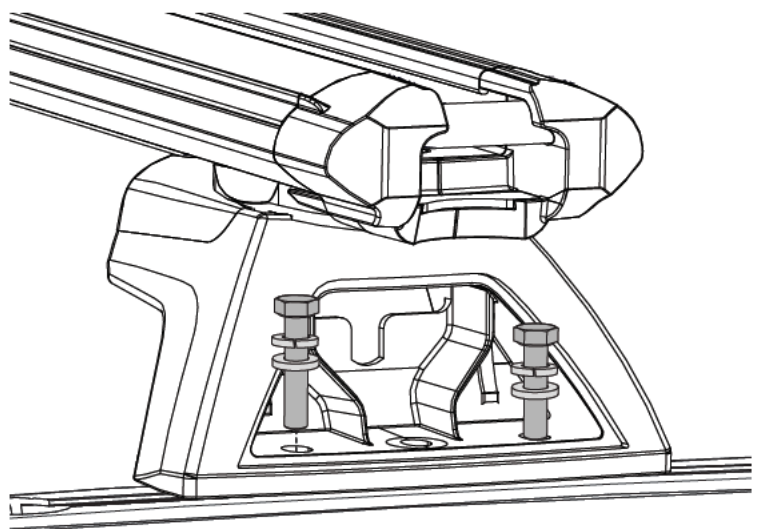

**19****SECURE BARS TO TRACKS**

Tighten all M6 Hex Screws to 5 Nm using a 10 mm Open Ended Spanner. **Do not over tighten.**

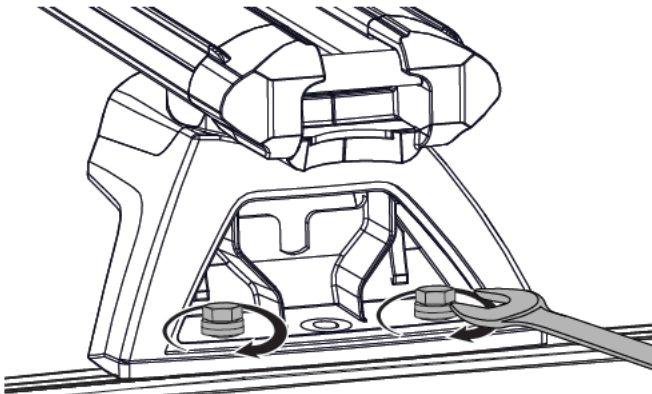
**20****CHECK BAR LEGS ARE SECURE**

Check all Bar Legs are secure.

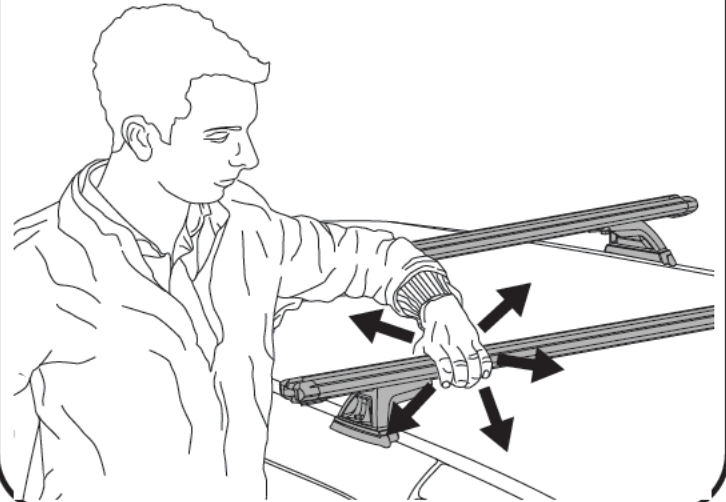
**21****FIT LEG COVERS**

Using the keys and Covers supplied in the LockNLoad Leg Kit, fit and lock all Leg Covers.

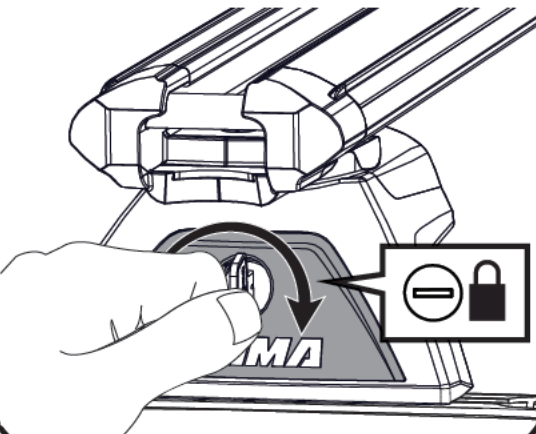
**22****BAR KEYS**

Place one key on the vehicle key ring and put the other away safely, or store with the spare vehicle key.

Write the key number (which is stamped on the key) in the box provided. Replacement keys are available from Yakima stockists, visit [www.yakima.com.au](http://www.yakima.com.au) or [www.yakima.co.nz](http://www.yakima.co.nz) to find your nearest store or contact us directly on 1800 143 548 (AU) or 0800 4776 722 (NZ).

Key Number:





[www.yakima.com.au](http://www.yakima.com.au)  
[www.yakima.co.nz](http://www.yakima.co.nz)  
[www.yakima.com](http://www.yakima.com)

**YAKIMA AUSTRALIA PTY. LTD**

17 Hinkler Court  
Brendale, QLD 4500  
Australia  
1800 143 548

**YAKIMA PRODUCTS, INC.**

4101 Kruse Way  
Lake Oswego, OR  
97035-2541  
USA  
888 925 4621