



LockNLoad™ Gutter Mount Kit

GUTTER MOUNT HEAVY DUTY ROOF RACK ATTACHMENT SYSTEM

MAXIMUM PRODUCT LOAD RATING: 2 Bars: 100 kg 3 Bars: 150 kg 4 Bars: 150 kg

IMPORTANT:

- **LOAD = WEIGHT OF PLATFORM or BARS + MOUNTING SYSTEM + ACCESSORIES + CARGO**
- **PLEASE REFER TO VEHICLE MANUFACTURER SPECIFICATIONS FOR MAX ROOF LOAD CAPACITY OF VEHICLE. THE LOWEST LOAD RATING APPLIES.**
- **OFFROAD RATING: SCAN QR CODE FOR LOCKNLOAD LOAD RATING GUIDE. REDUCTIONS MAY APPLY.**



FIRST TIME INSTALLATION

- Please read instructions carefully before installation.
- Check the contents of kit. Contact your YAKIMA dealer if any parts appear missing, incorrect or damaged.
- Clean your roof thoroughly prior to fitting the LockNLoad Gutter Mount Heavy Duty Roof Rack System.
- Place these instructions in the vehicle's glove box after installation is complete.



TOOLS REQUIRED:

- Tape Measure
- Scissors
- Rubber Mallet (Optional)
- 13 mm Socket Wrench
- 4 mm Hex Key

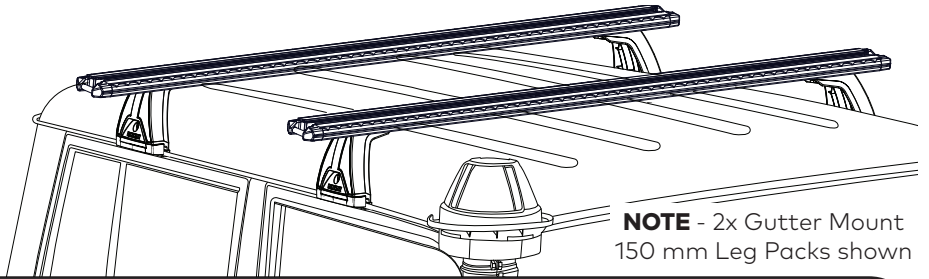

NOTE - 2x Gutter Mount
150 mm Leg Packs shown

KIT CONTENTS

ITEM	COMPONENT	QTY	ITEM	COMPONENT	QTY
1.	Rubber Skirt	x2	9.	Locking Clip Base	x2
2.	Nut Plate	x2	10.	Locking Clip	x2
3.	Leg Cover	x2	11.	Tamper Proof Torx Key	x1
4.	Washer M8	x4	12.	Tamper Proof Torx Button Head Screw	x4
5.	Spring Washer M8	x4	13.	Spring Washer M6	x4
6.	Hex Bolt M8	x4	14.	Washer M6	x4
7.	Gutter Mount Leg 110/150/210 mm	x2	15.	Mount Plate	x2
8.	Yakima Key Set	x1	16.	Rubber Foot Grip	x2



BAR COMPONENTS SOLD SEPARATELY

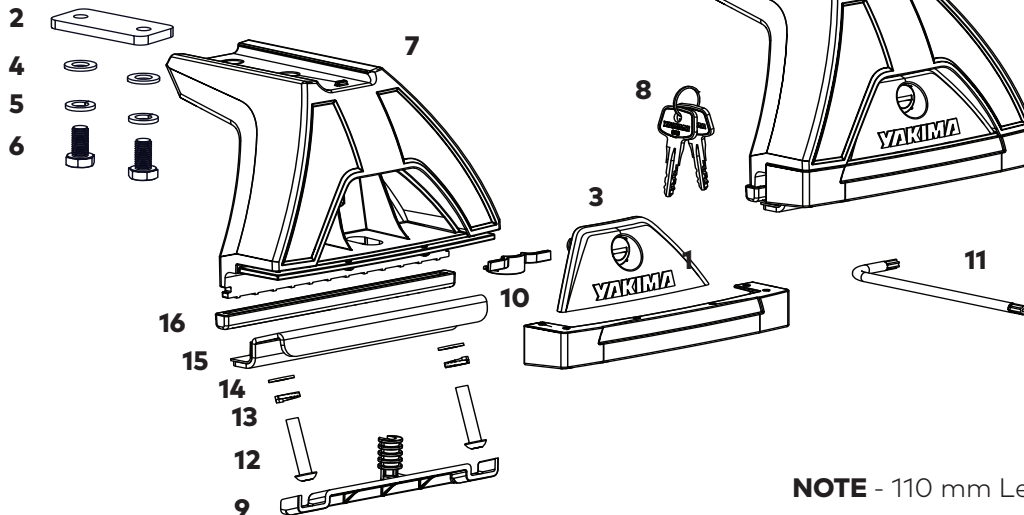

NOTE - 110 mm Leg shown

INSTALLATION TO TRIMHD BARS - SEE PAGES 2 - 6

LOCKNLOAD PLATFORM INSTALLATION TO GUTTER MOUNT LEGS - SEE PAGES 6 - 7

1 REMOVE LEG COVERS.

Using the keys remove all leg covers.

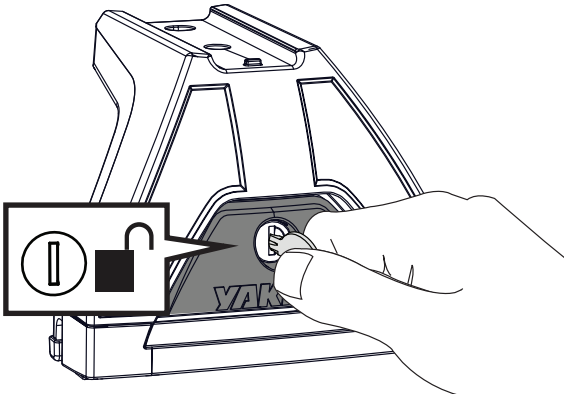

2 REMOVE FOOT BASE.

Remove locking clip to release locking clip base underneath rubber skirt. Keep parts aside.

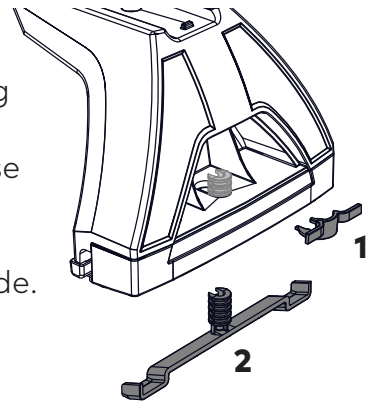

3 LOOSEN GUTTER MOUNT PLATE.

To loosen gutter mount plate, partially unscrew bolt and washer assemblies using the tamper proof torx key.

Ensure there is a sufficient gap between the gutter mount plate and foot grip to insert between vehicle gutter.

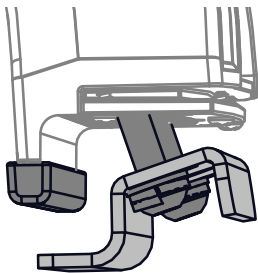

4 LEG ASSEMBLY.

Position nut plates over holes on top of legs.

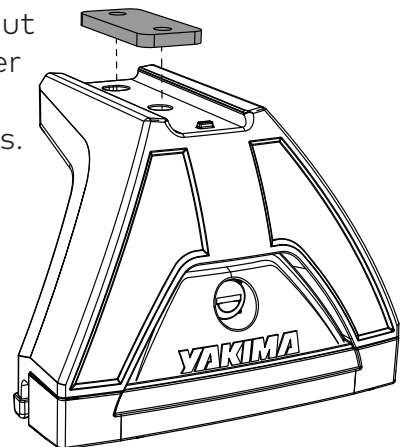

5

Assemble 1 x M8 spring washer and 1 x M8 washer onto each M8 hex bolt in the order shown.

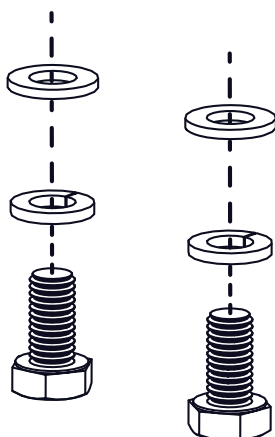

6

Loosely finger tighten nut plates to legs as shown using the screw assemblies from the previous step.

For the next step, ensure there is a sufficient gap between the nut plates and legs.

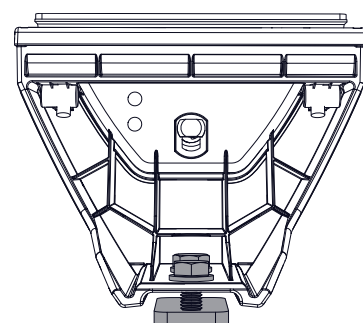

7 INSERT LEGS.

Slide leg assemblies into the underside channel of TrimHD bars (sold separately). If leg assemblies will not slide in, loosen screws to increase gap.

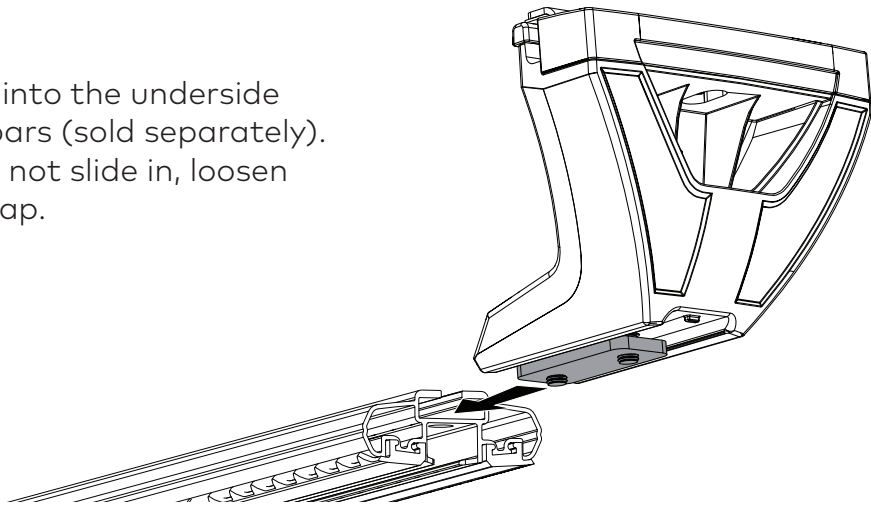

8 BAR LOCATION.

IMPORTANT: Before beginning bar installation, identify where along the gutter you want the front and rear bars fitted.

We recommend a minimum of 700 mm between bars.

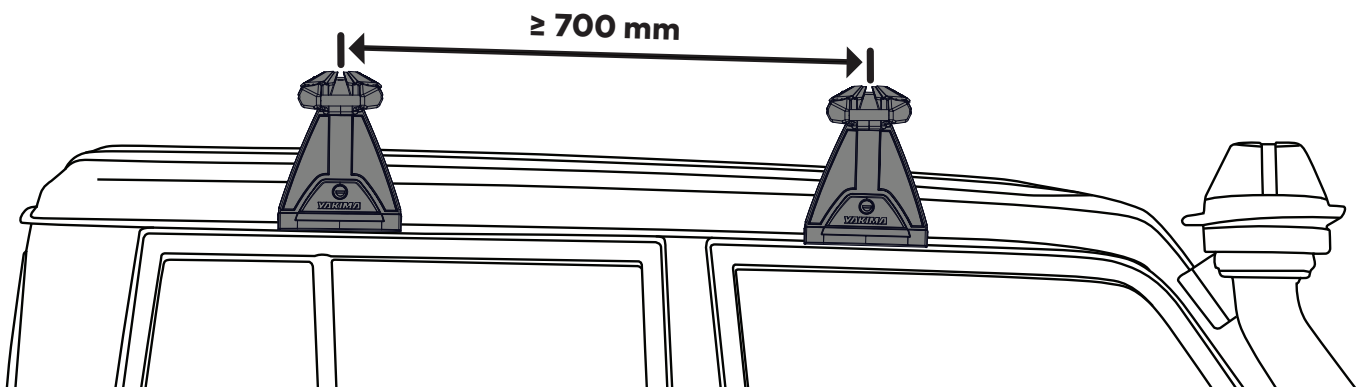

9 BAR PLACEMENT.

Carefully place a bar assembly over vehicle. **Take care not to damage vehicle.** Slide legs along bar until both legs are positioned inside the vehicle gutter. Use a tape measure to ensure even bar overhang on each side, re-adjust if required. Finger tighten one screw on each leg to secure leg position along bar.

Repeat process for remaining bar assembly then carefully remove bars from vehicle.

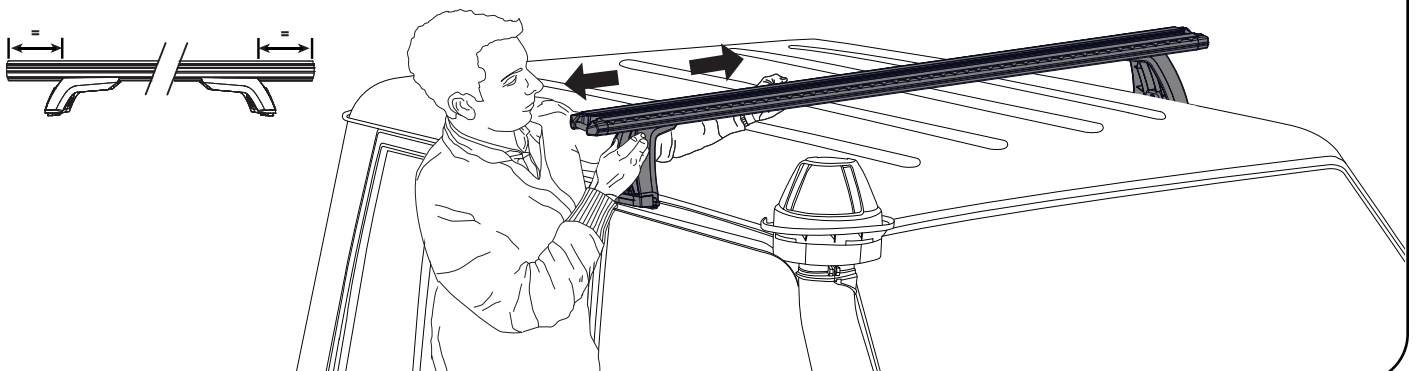

10

CHECK BAR SLOT MEASUREMENTS.

Using the measurements on underside of bar, record leg to underside slot distance of each bar in the table (right). Ensure measurement is taken from the centre of the legs as shown. The ends of each bar should be the same measurement respectively, if not, repeat step 9.

BAR SLOT MEASUREMENTS	
Front Bar (X)	Rear Bar (Y)
_____ mm x2	_____ mm x2

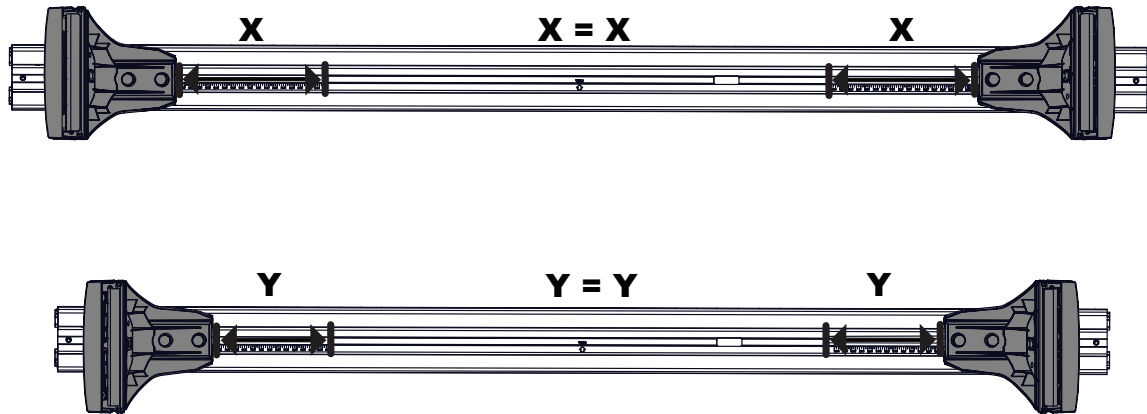

11

SECURE LEGS TO BARS.

Tighten all M8 hex bolts to 7 Nm using a 13 mm socket wrench.

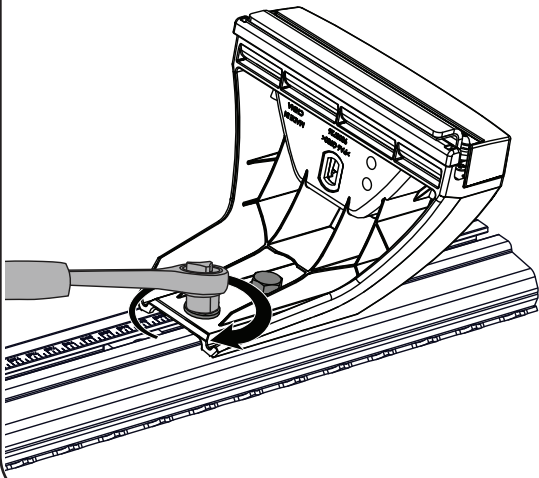

12

BAR SLOT COVERS.

Cut bar slot covers as per measurements recorded in the table on step 10 and push into underside channel of front and rear bar ends as shown.

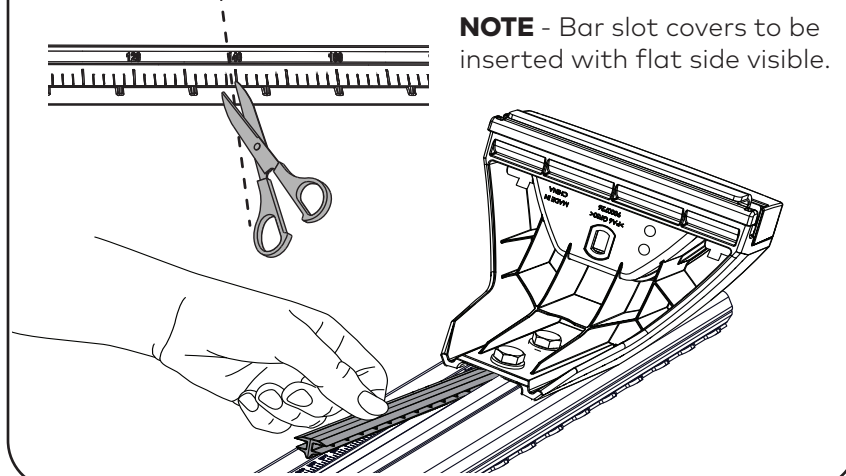

13

BAR SLOT COVERS (OUTSIDE LEG).

Measure the bar channel outside of the legs and subtract 20 mm from this measurement.

Using the remaining pieces of slot cover from step 12, cut to this length and insert into the underside channel of each bar end as shown.

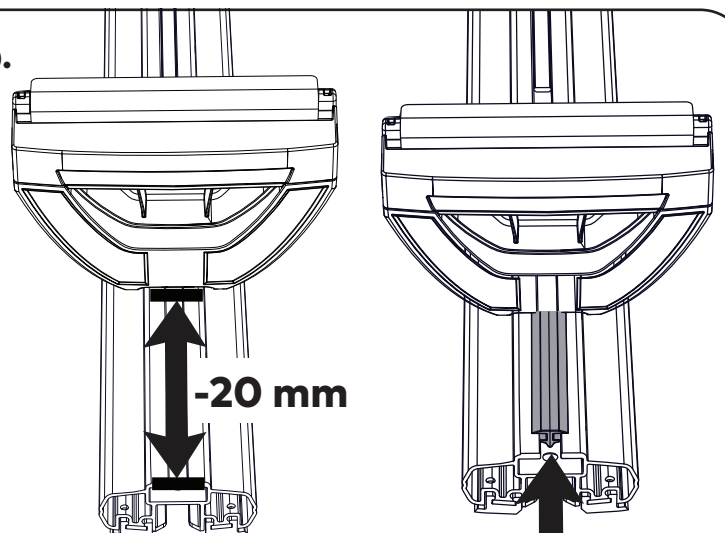

14

SECURE END CAPS TO BARS.

Insert the end caps as shown. A rubber mallet can be used to assist installation.

Secure using plastite screw from your TrimHD bar kit. Tighten using a 4 mm hex key.

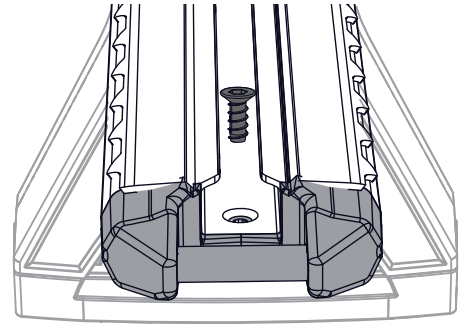
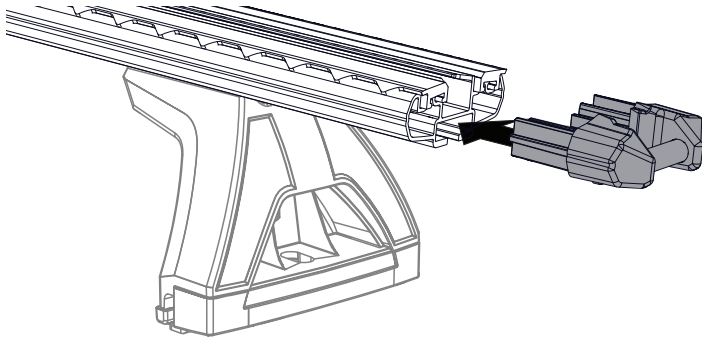

15

BAR FITMENT.

Carefully place bar assembly over vehicle locating the rubber foot grip into the vehicle gutter and the mount plate hooking under the gutter. **Take care not to damage vehicle.**

Tighten bolt and washer assemblies to 4 Nm using the tamper proof torx key.

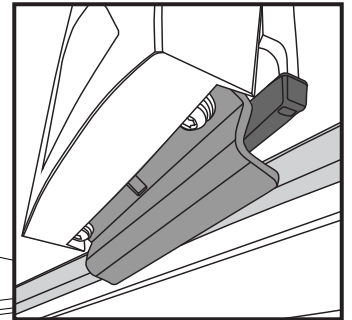
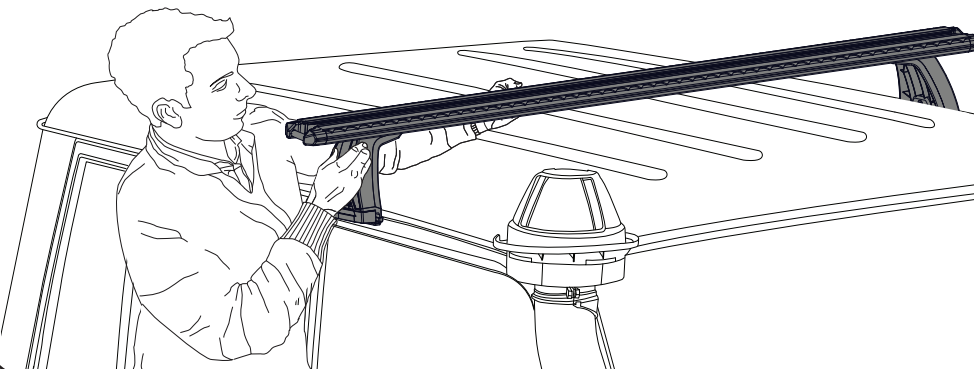

16

RE-SECURE FOOT BASE.

Re-insert locking clip base underneath rubber skirt and secure with locking clip.

17

CHECK BAR LEGS ARE SECURE.

Check all bar legs are secure.

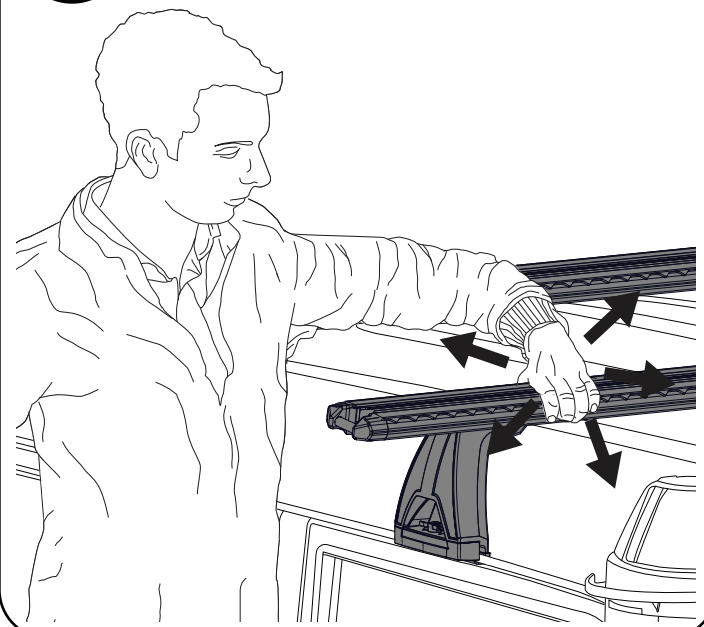
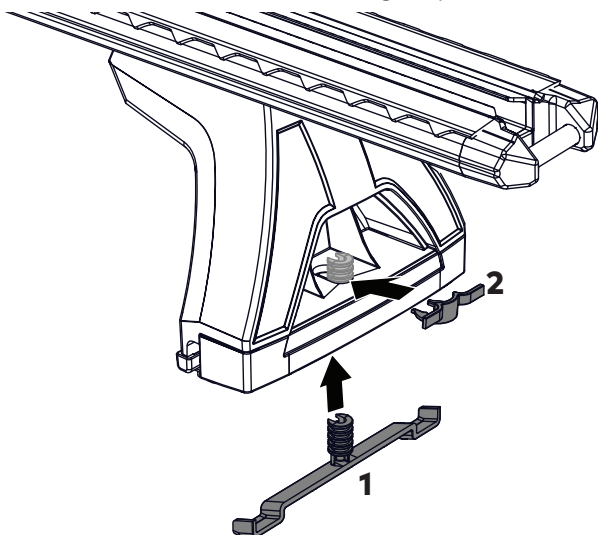

18**FIT LEG COVERS.**

Using the keys and covers, fit and lock all leg covers.

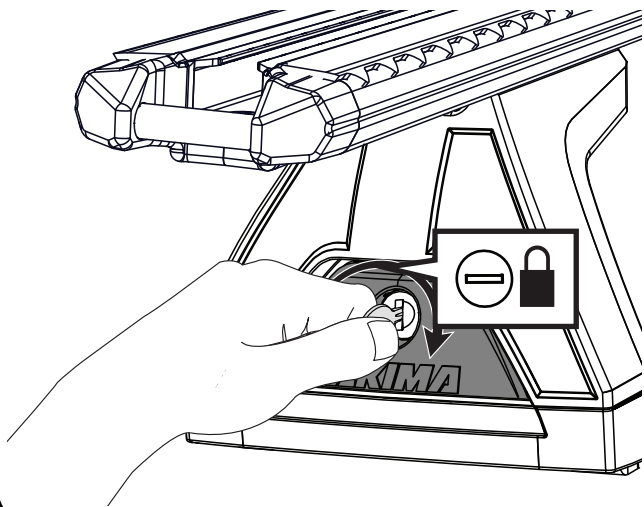
**19****BAR KEYS.**

Place one key on the vehicle key ring and put the other away safely, or store with the spare vehicle key.

Write the key number (which is stamped on the key) in the box provided. Replacement keys are available from yakima stockists, visit www.yakima.com.au or www.yakima.co.nz to find your nearest store or contact us directly on 1800 143 548 (au) or 0800 4776 722 (nz).

Key Number: _____

LOCKNLOAD PLATFORM INSTALLATION TO GUTTER MOUNT LEGS**1****REMOVE LEG COVERS.**

Using the keys remove all leg covers.

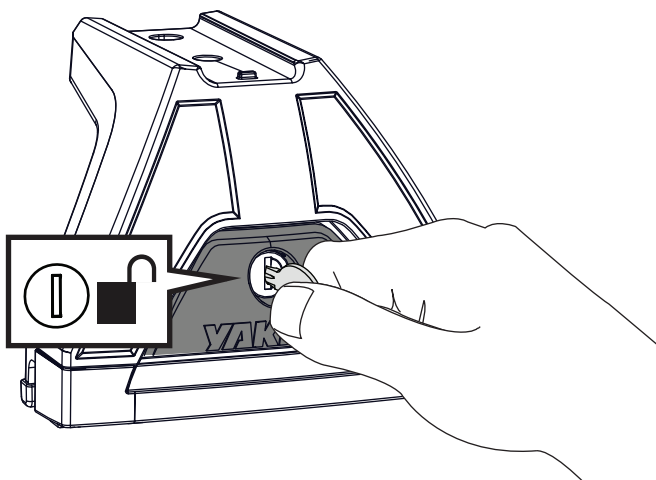
**2****REMOVE FOOT BASE.**

Remove locking clip to release locking clip base underneath rubber skirt. Keep parts aside.

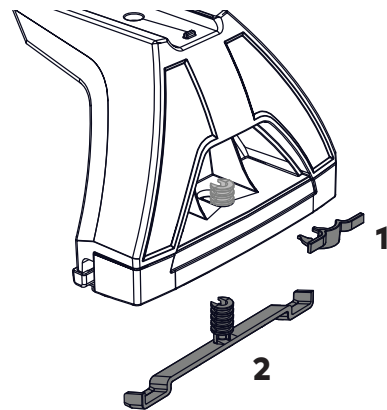
**3****LOOSEN GUTTER MOUNT PLATE.**

To loosen gutter mount plate, partially unscrew bolt and washer assemblies using the tamper proof torx key.

Ensure there is a sufficient gap between the gutter mount plate and foot grip to insert between vehicle gutter.

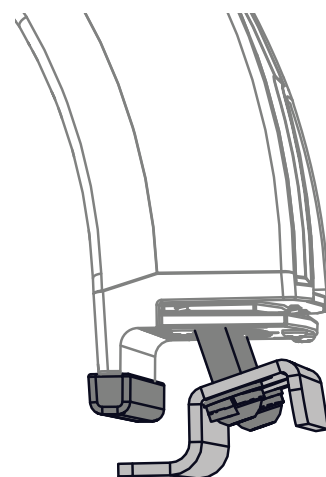



**NOW SWITCH TO YOUR LOCKLOAD PLATFORM
INSTRUCTIONS AND CONTINUE FROM THE
'LEG MOUNTING INSTRUCTIONS FOR GUTTER MOUNT &
MK1 LEGS' PAGE.**

4

LEG LOCATION.

Place legs into intended position in vehicle gutter, locating the rubber foot grip into the vehicle gutter and the mount plate hooking under the gutter. **Take care not to damage vehicle.**

We recommend spacing between 700 mm - 1000 mm apart.

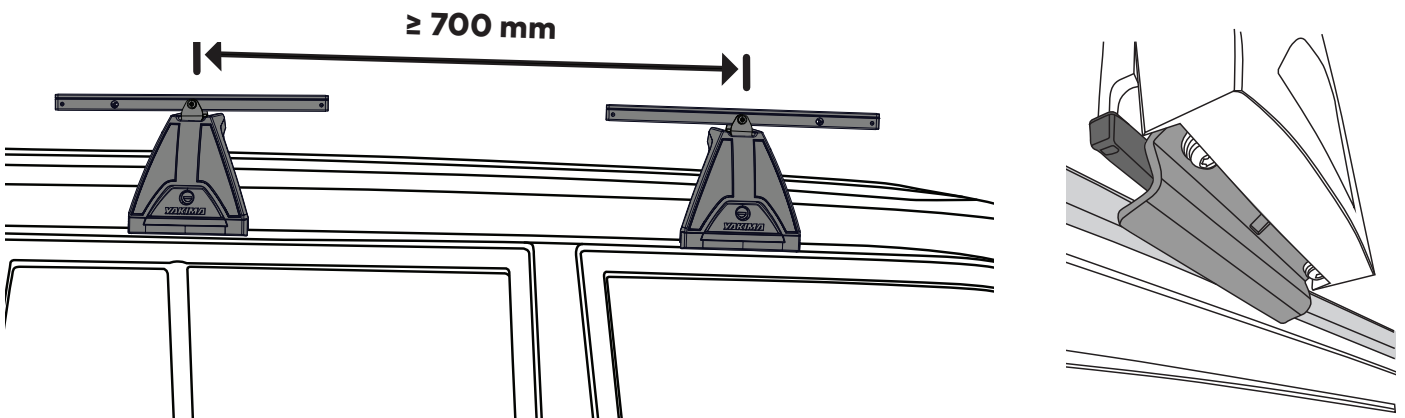

5

SECURE LEGS.

Finger tighten bolt and washer assemblies to hold legs in place.

Ensure legs are square across the vehicle.

When all are aligned, use supplied tamper proof torx key to tighten into place to 4 Nm.

Take care not to damage vehicle.

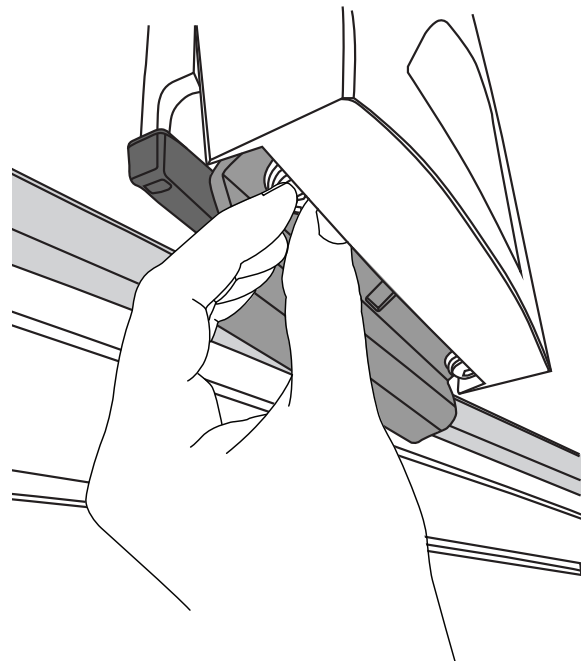

6 RE-SECURE FOOT BASE.

Re-insert locking clip base underneath rubber skirt and secure with locking clip.

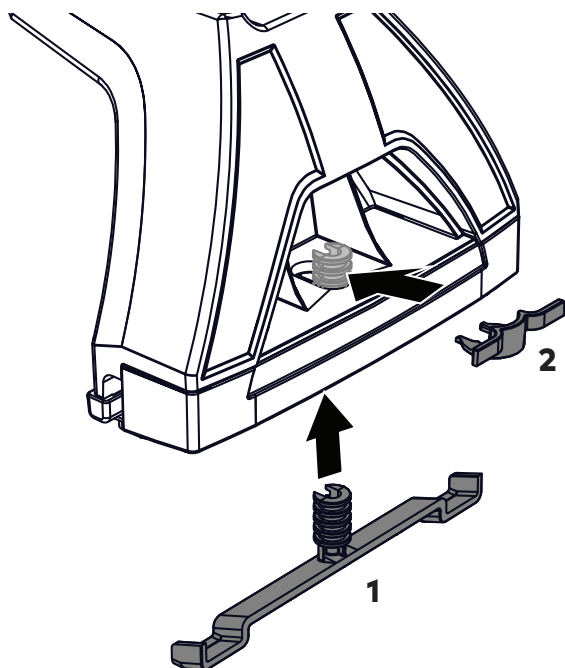

7 FIT LEG COVERS.

Using the keys and covers, fit and lock all leg covers.

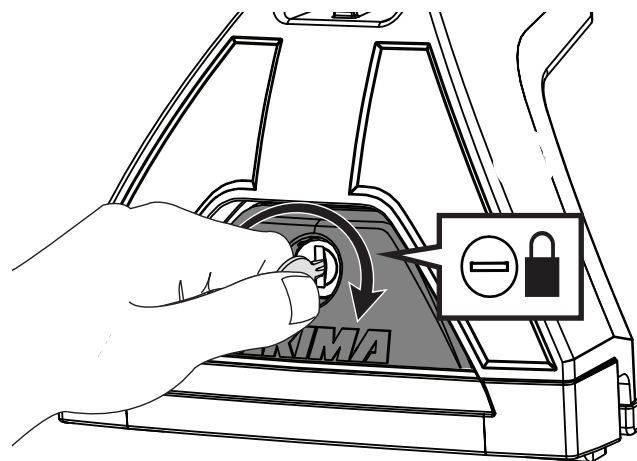

8 LEG KEYS.

Place one key on the vehicle key ring and put the other away safely, or store with the spare vehicle key.

Write the key number (which is stamped on the key) in the box provided. Replacement keys are available from yakima stockists, visit www.yakima.com.au or www.yakima.co.nz to find your nearest store or contact us directly on 1800 143 548 (AU) or 0800 4776 722 (NZ).

Key Number:



NOW SWITCH TO YOUR LOCKNLOAD PLATFORM INSTRUCTIONS AND CONTINUE FROM THE 'PLATFORM MOUNTING INSTRUCTIONS' PAGE.

This page intentionally left blank



www.yakima.com.au
www.yakima.co.nz
www.yakima.com
www.yakima.eu

YAKIMA AUSTRALIA PTY LTD

17 Hinkler Court
Brendale, QLD 4500
Australia
1800 143 548

YAKIMA PRODUCTS, INC.

4101 Kruse Way
Lake Oswego, OR
97035-2541
USA
888 925 4621
yakima.com/support