



LockNLoad™ Flush Rail Mounting Kit

MITSUBISHI PAJERO SPORT 2015+
FLUSH RAIL HEAVY DUTY ROOF RACK SYSTEM

MAXIMUM PRODUCT LOAD RATING: 100 kg 

IMPORTANT:

- **LOAD = WEIGHT OF PLATFORM or BARS + MOUNTING SYSTEM + ACCESSORIES + CARGO**
- **PLEASE REFER TO VEHICLE MANUFACTURER SPECIFICATIONS FOR MAX ROOF LOAD CAPACITY OF VEHICLE. THE LOWEST LOAD RATING APPLIES.**
- **OFFROAD RATING: SCAN QR CODE FOR LOCKNLOAD LOAD RATING GUIDE. REDUCTIONS MAY APPLY.**



FIRST TIME INSTALLATION

- Please read instructions carefully before installation.
- Check the contents of kit. Contact your YAKIMA dealer if any parts appear missing or damaged.
- Clean your roof thoroughly prior to fitting the LockNLoad Flush Rail Heavy Duty Roof Rack System.
- Place these instructions in the vehicle's glove box after installation is complete.



TOOLS REQUIRED:

- 4 mm Ball End Allen Key
- 5 mm Allen Key
- 13 mm Ring Spanner
- #2 Phillips Head Screwdriver
- Scissors
- Tape Measure
- Marking Pen (Optional)
- Torque Wrench (Optional)

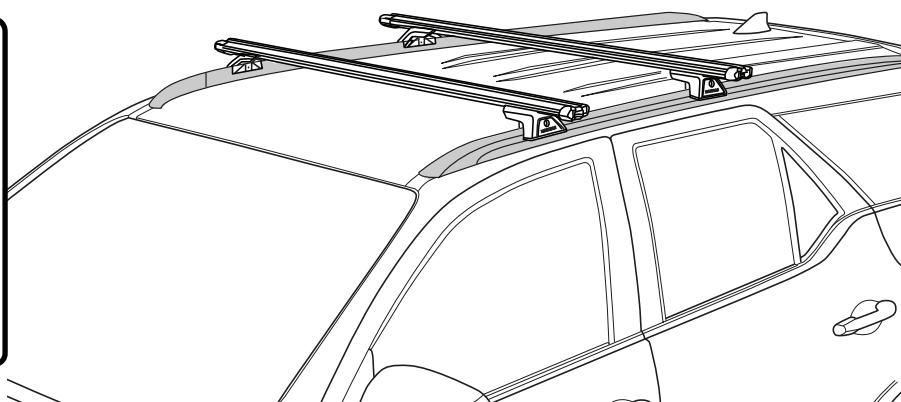

KIT CONTENTS

ITEM	COMPONENT	QTY	ITEM	COMPONENT	QTY
1.	Foot Extrusion	x4	4.	Claw Extrusion	x8
2.	Rubber Foot Pad	x4	5.	Rubber Clamp Pad	x8
3.	Rubber Foot Pad	x4	6.	Pinned Grip Plate	x4

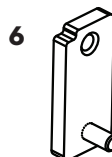
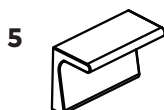
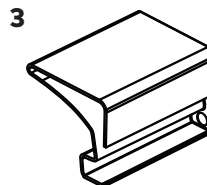
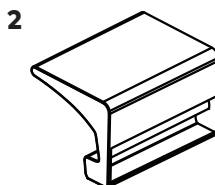
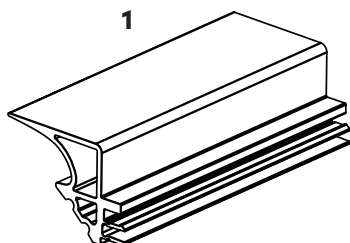

LEG AND BAR COMPONENTS SOLD SEPARATELY

8000356

TABLE OF CONTENTS

INSTALLATION OF LOCKNLOAD PLATFORM TO FLUSH RAIL LEGS	2
INSTALLATION OF LOCKNLOAD CROSSBARS.	6

INSTALLATION OF LOCKNLOAD PLATFORM TO FLUSH RAIL LEGS

1 REMOVE LEG COVERS

Using the keys supplied in the LockNLoad Leg Kit (sold separately), remove all Leg Covers.

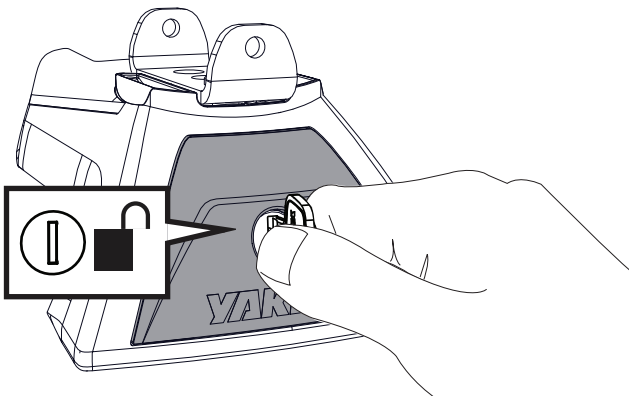

2 CLAW ASSEMBLY

Insert a Pinned Grip Plate into each of the Clamp Claws from the LockNLoad leg kit.

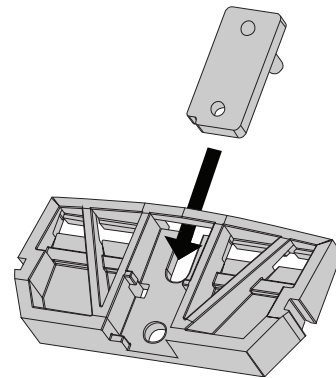

3 FOOT ASSEMBLY

Slide Rubber Foot Pads onto each Foot Extrusion.

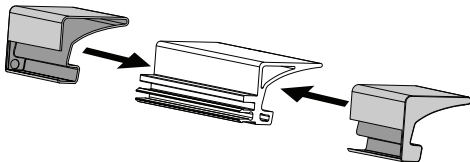

Slide Rubber Clamp Pads over each of the Claw Extrusions.

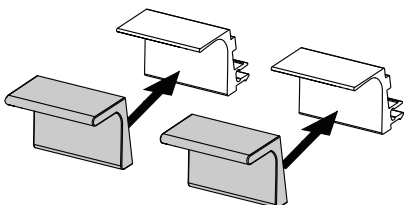

4

Push padded Claw Extrusions into the Clamp Claws. (When assembled onto a vehicle these will click into position).

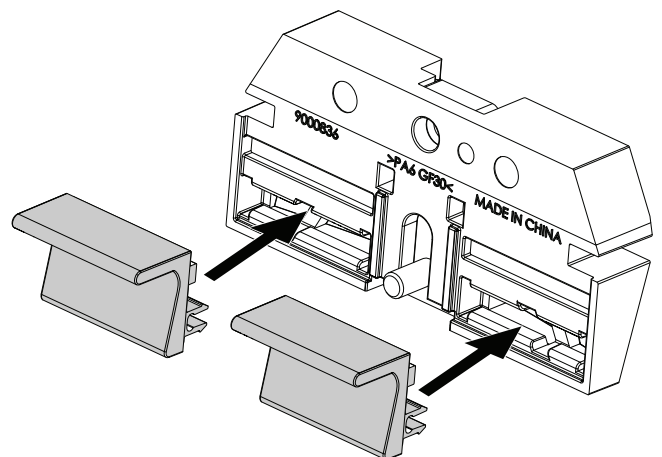

- 5** Push padded Foot Extrusions into the rear cavity of LockNLoad Legs. (When assembled onto a vehicle these will click into position).

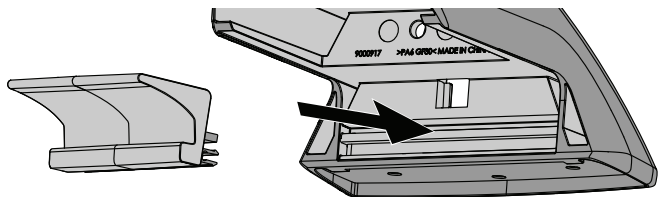

6 LEG ASSEMBLY

- Slide the Claw assembly into the LockNLoad Leg, as shown. Insert the M6 bolt and washer from the Leg kit into the Leg and wind (six revolutions) into the grip plate.

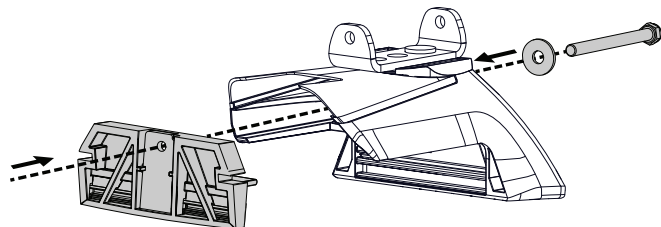

7 INSTALL MOUNTING BLOCKS

- Place Mounting Block from Platform kit on top of each Leg assembly, lining up the rivnut holes on Mounting Block with holes on tabs of Leg Mounting Bracket. Secure with M6 Capscrews and Washers from Platform kit, as shown. Tighten all screws to 4 Nm with a 4 mm Ball End Allen Key or suitable Torque Wrench.

Note: The Mounting Block assembly will still have movement after securing which is intended.

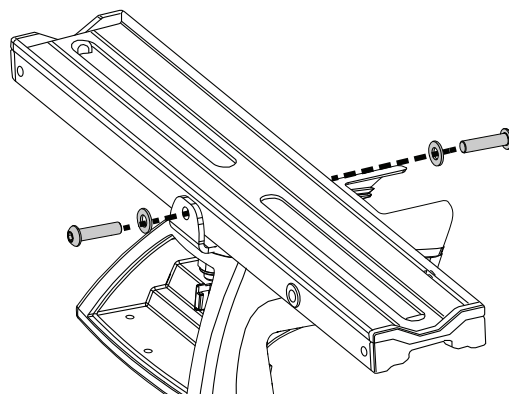
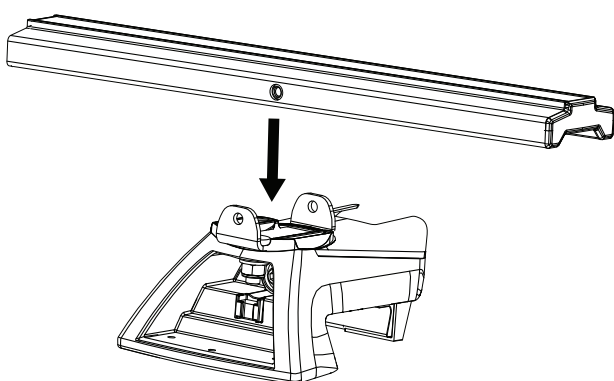

8 LEG LOCATION

- Place front Legs onto the vehicle rail aligning the Grip Plate Pin with the factory pin hole closest to the front of the vehicle.

Place rear Legs 800 mm from Front Legs, aligning Grip Plate Pin with the factory pin hole closest to the rear of the vehicle.

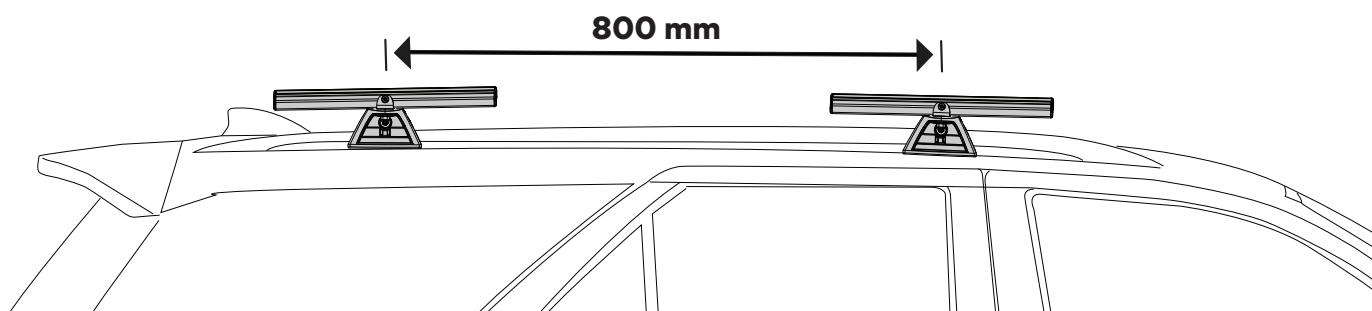

9

SECURE LEGS

Secure Claw assemblies to the vehicle rail using a 5 mm Allen Key or Torque Wrench.

Torque to 4 Nm.

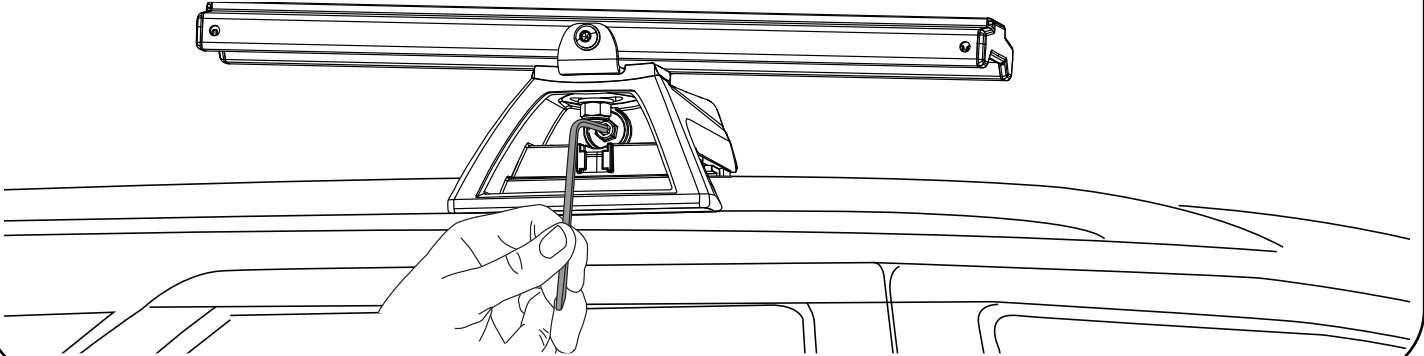
**10**

ASSEMBLE LOCKNLOAD PLATFORM

If Platform was purchased unassembled, follow Steps 1 - 9 on Pages 4 - 7 of the Platform Assembly instructions (footer number 28-13-337) to piece Platform together.

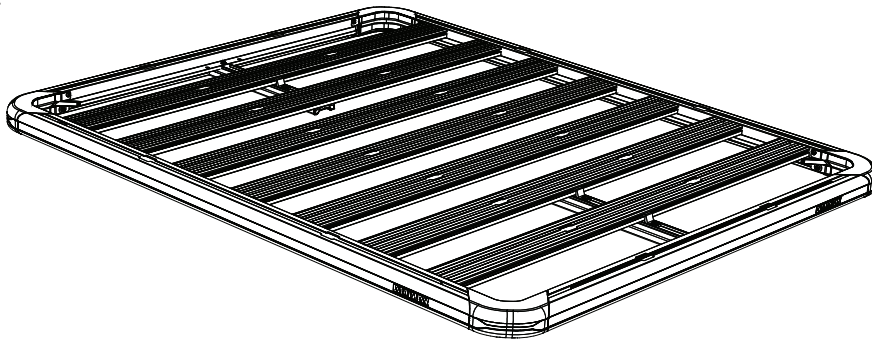
**11**

LIFT PLATFORM ONTO VEHICLE

With the help of an assistant, carefully lift assembled Platform up and onto Mounting Blocks on vehicle roof. Centre Platform evenly on Legs so there is equal overhang on both sides and ideally at front and rear.

Follow LockNLoad Platform Vehicle Mounting instructions from Step 3 to complete install.

NOTE - Wind Deflector, if used, is to be installed at the front of the vehicle (sold separately).

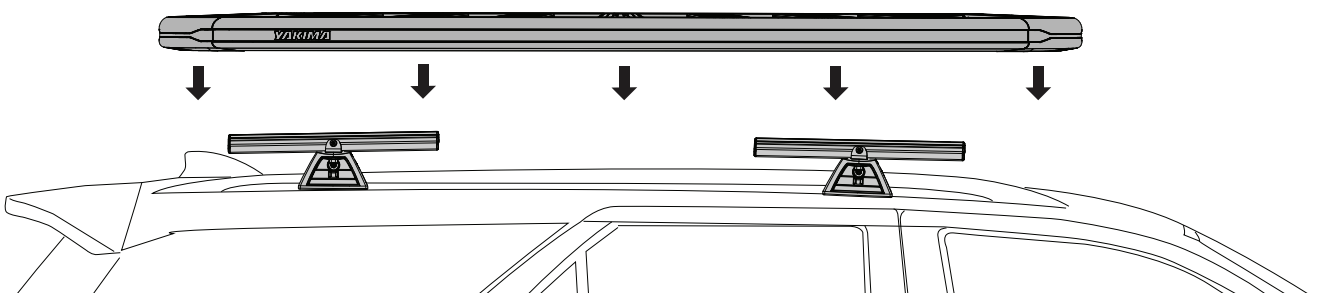

12**TIGHTEN PIVOT ASSEMBLY**

Use Spanner or Torque Wrench to tighten M8 Nuts on each Leg to 7 Nm.

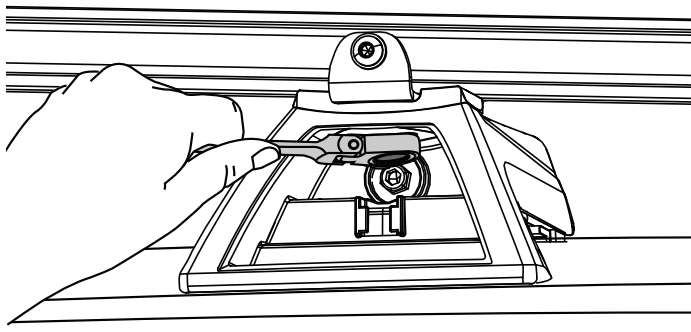
**13****FIT LEG COVERS**

Fit Covers onto Legs and lock using the keys supplied in the LockNLoad Leg Kit.

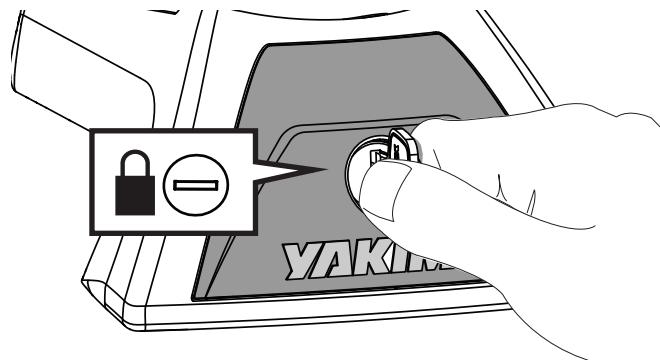
**14****LEG KEYS**

Place one key on the vehicle key ring and put the other away safely, or store with the spare vehicle key.

Write the key number (which is stamped on the key) in the box provided.
Replacement keys are available from Yakima stockists, visit www.yakima.com.au or www.yakima.co.nz to find your nearest store or contact us directly on 1800 143 548 (AU) or 0800 4776 722 (NZ).

Key Number:

INSTALLATION OF LOCKNLOAD CROSSBARS

1

REMOVE LEG COVERS

Using the keys supplied in the LockNLoad Leg Kit (sold separately), remove all Leg Covers.

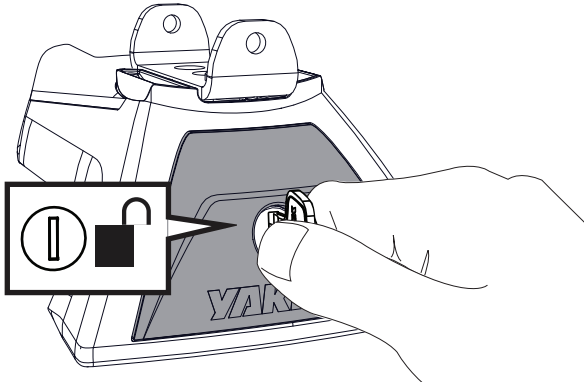

2

CLAW ASSEMBLY

Insert a Pinned Grip Plate into each of the Clamp Claws from the LockNLoad Leg Kit.

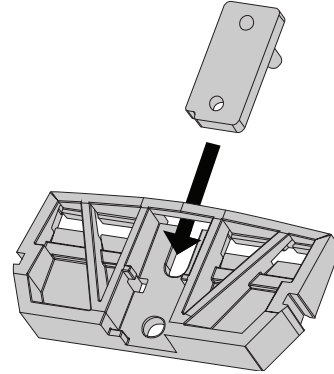

3

FOOT ASSEMBLY

Slide Rubber Foot Pads onto each Foot Extrusion.

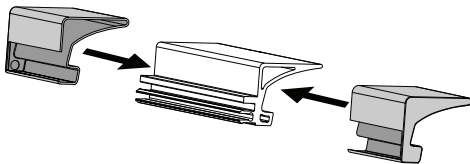

Slide Rubber Clamp Pads over each of the Claw Extrusions.

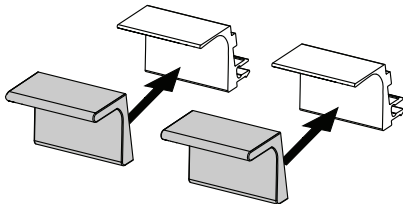

4

Push padded Claw Extrusions into the Clamp Claws. (When assembled onto a vehicle these will click into position).

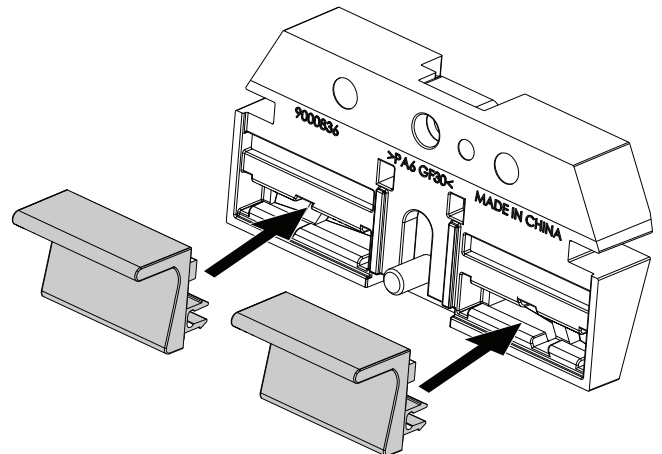

5

Push padded Foot Extrusions into the rear cavity of LockNLoad Legs. (When assembled onto a vehicle these will click into position).

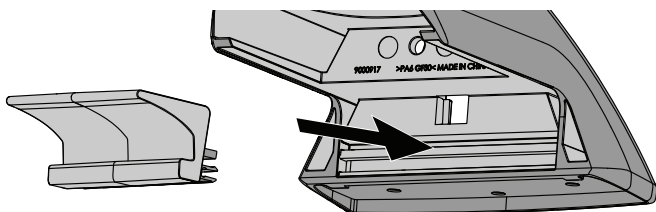

6

LEG ASSEMBLY

Slide the Claw assembly into the LockNLoad Leg, as shown. Insert the M6 bolt and washer from the Leg kit into the Leg and wind (six revolutions) into the grip plate.

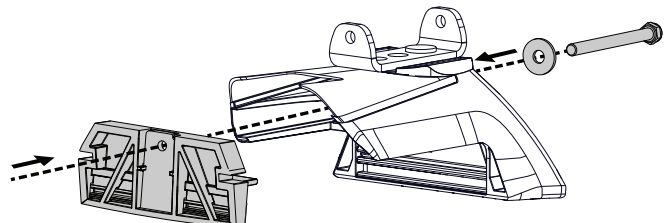

7

REMOVE PLATFORM HARDWARE

Remove nut and washer which have been loosely pre-installed as shown. Remove Coach Bolt and Mounting Bracket.

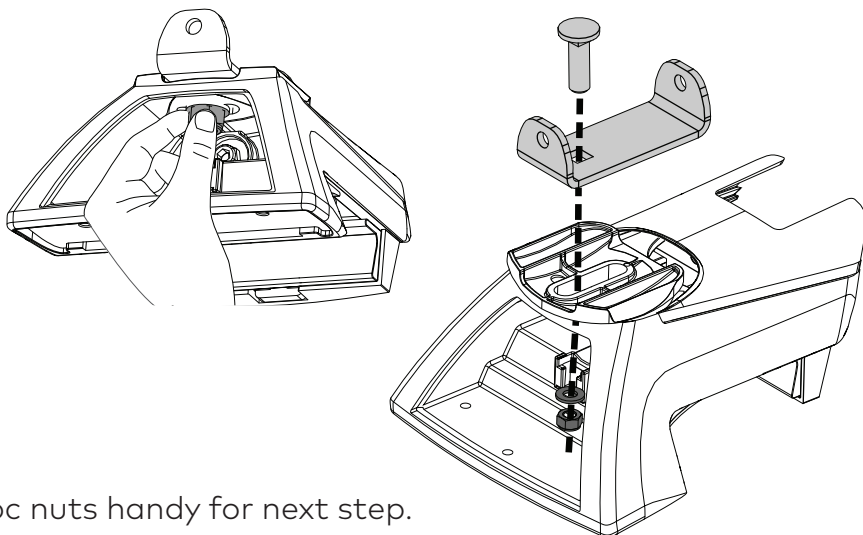

NOTE: Keep removed nyloc nuts handy for next step.

8

PIVOT ASSEMBLY

Assemble as shown. Loosely tighten the M8 screw and ensure a sufficient gap remains between Nut Plate and Leg to allow Bar to slide through in next step.

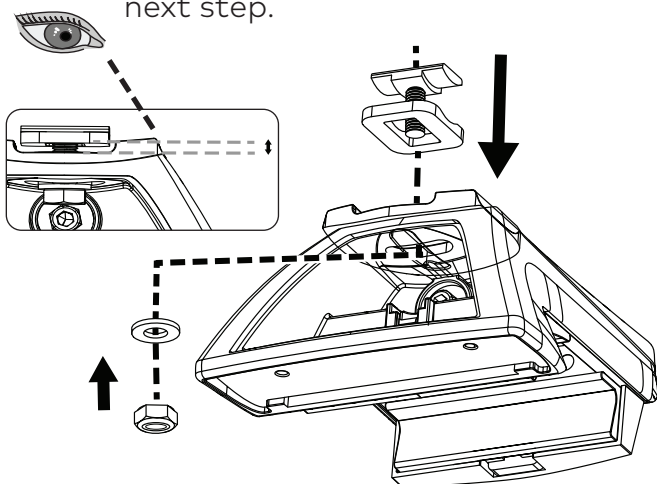

9

INSERT LEGS

Remove the End Caps from LockNLoad Bars and slide Leg assemblies into the underside channel of each of the Bars (sold separately).

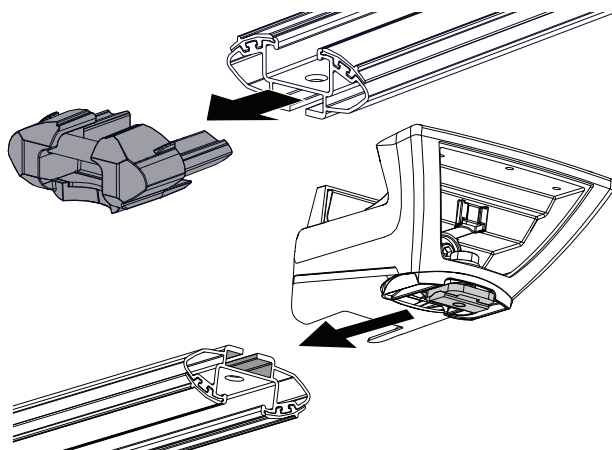

10

BAR LOCATION

Look for the factory pin holes on the roof rails. For the front Bar, we recommend using the hole closest to the front of the vehicle and for the rear Bar, the hole closest to the rear of the vehicle.

Bar spacing should be approximately 800 mm.

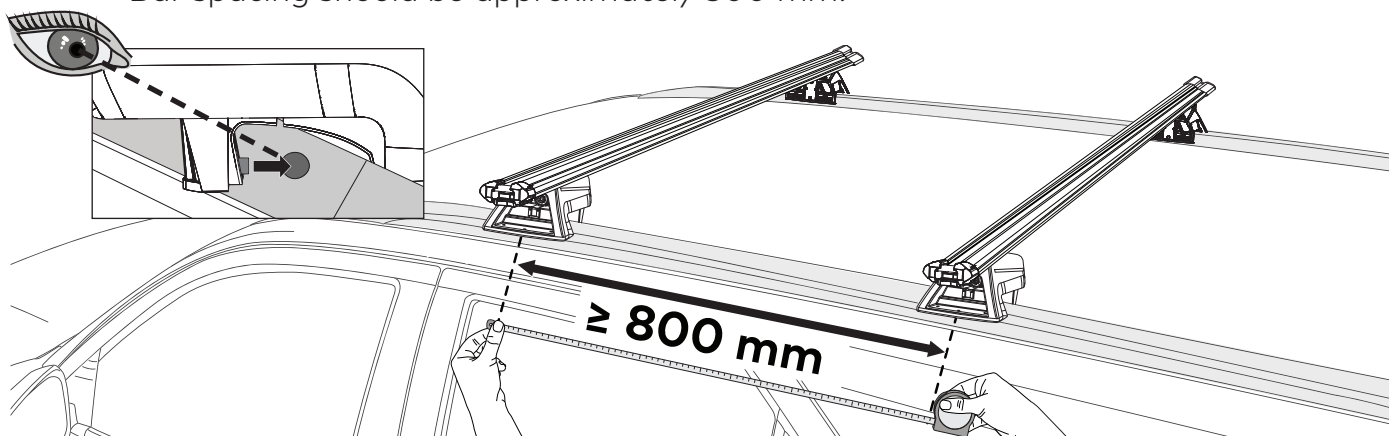

11

BAR PLACEMENT

Carefully place Bar assembly onto vehicle. **Take care not to damage vehicle.** Slide Legs along Bar until foot clamp sits snug against vehicle rail with pins positioned in rail holes.

Secure the Claw assembly to the vehicle rail using a 5 mm Allen Key or Torque Wrench.

Torque to 4 Nm.

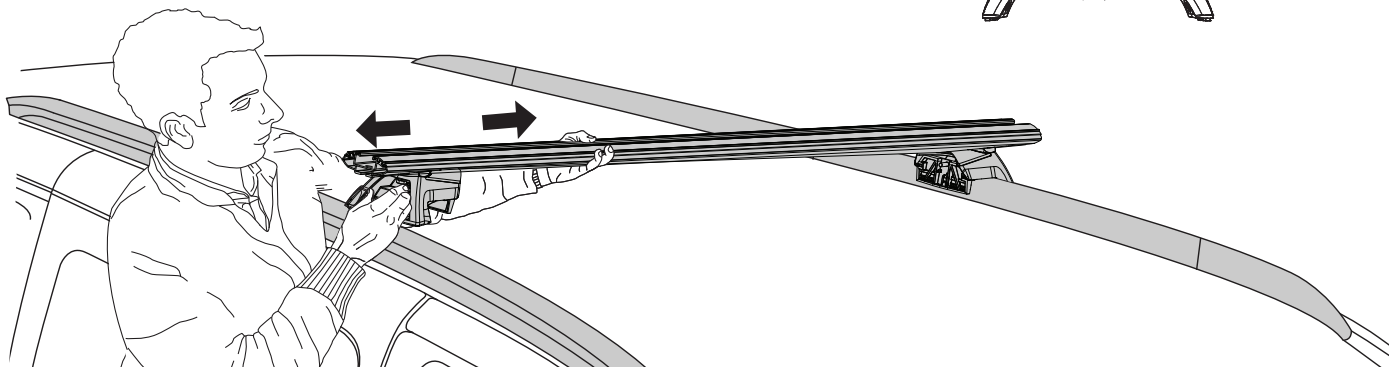

12

CHECK BAR SLOT MEASUREMENTS

Using a Tape Measure, record Leg to underside slot distance of each Bar in the table (right). Ensure measurement is taken from the centre of the Legs as shown. The ends of each bar should be the same measurement respectively, if not, repeat Step 11.

BAR SLOT MEASUREMENTS	
Front Bar (X)	Rear Bar (Y)
_____mm x2	_____mm x2

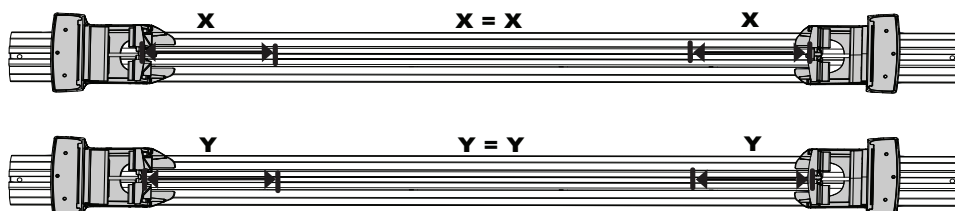

13

SECURE LEGS TO BARS

Given that the pivot assembly allows for degrees of freedom, check all plates are evenly arranged and bars are in the desired position/angle before tightening M8 Hex Bolt to 7 Nm.

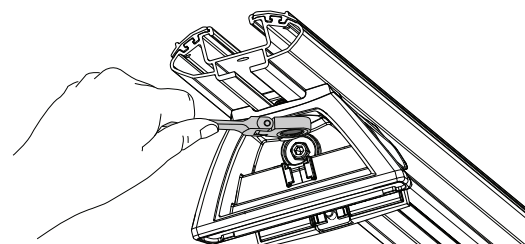

14

BAR SLOT COVERS

Cut Bar Slot Covers as per measurements recorded in the table on Step 12 and push into underside channel of front and rear Bar ends as shown.

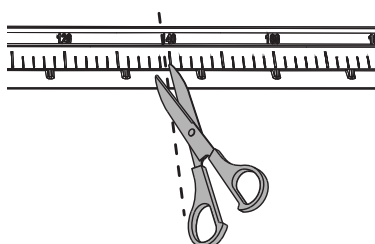

NOTE - Bar Slot Covers to be inserted with flat side visible.

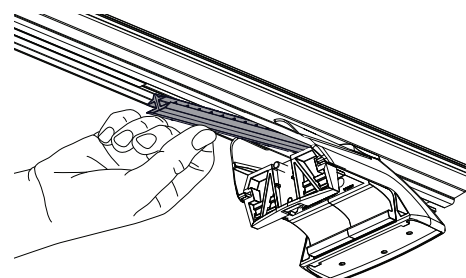

15**BAR SLOT COVERS (OUTSIDE LEG)**

Measure the Bar channel outside of the Legs and subtract 20 mm from this measurement.

Using the remaining pieces of Slot Cover from Step 14, cut to this length and insert into the underside channel of each Bar end as shown.

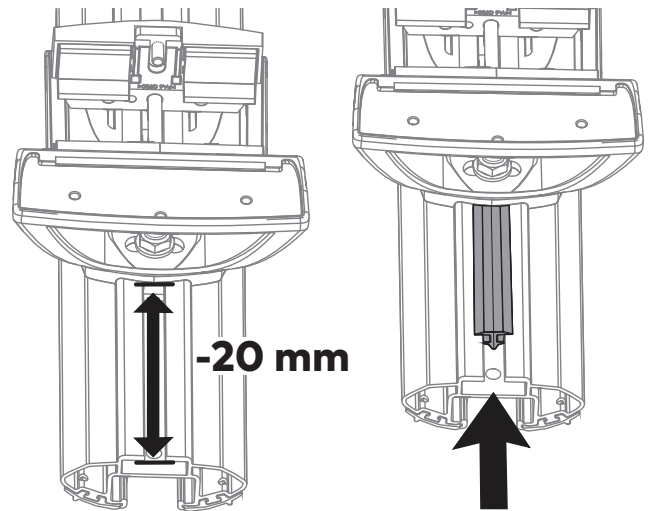
**16****SECURE END CAPS TO BARS**

Insert the End Caps as shown. A Rubber Mallet can be used to assist installation.

Secure using Plastite Screw. Tighten using a #2 Phillips Head Screwdriver.

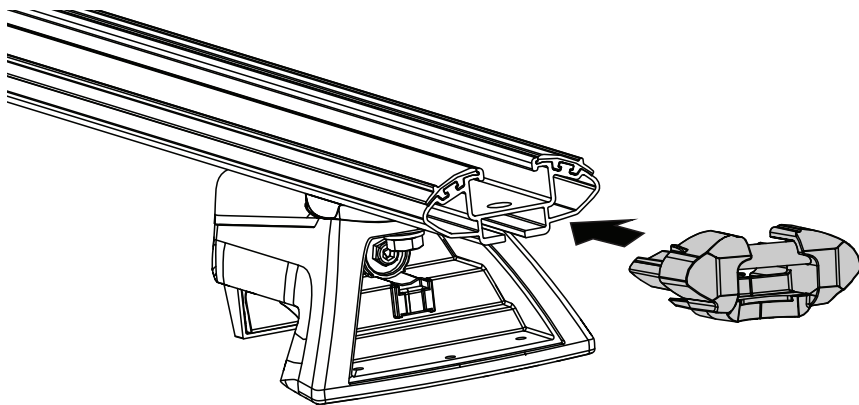
**17****CHECK BAR LEGS ARE SECURE**

Check all Bars/Legs are secure.

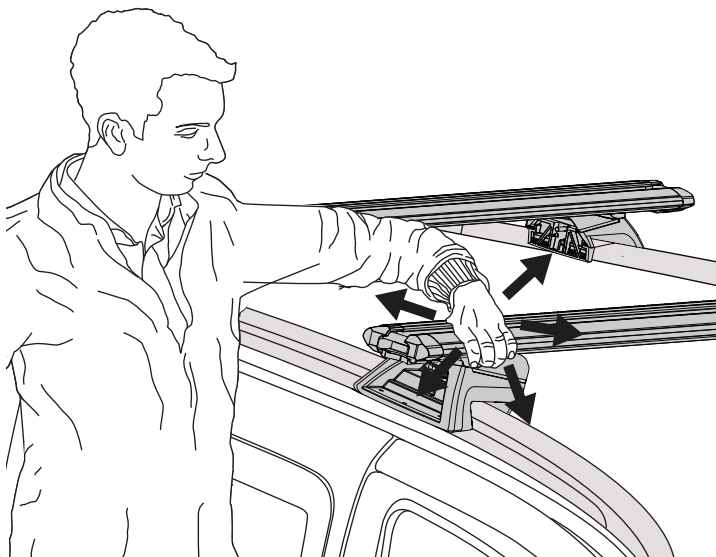
**18****FIT LEG COVERS**

Using the Keys and Covers supplied in the LockNLoad Leg Kit, fit and lock all Leg Covers.

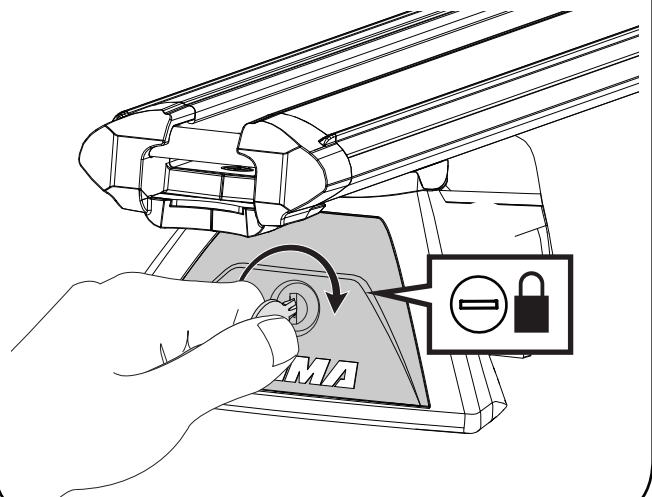

19

BAR KEYS

Place one key on the vehicle key ring and put the other away safely, or store with the spare vehicle key.

Write the key number (which is stamped on the key) in the box provided. Replacement keys are available from Yakima stockists, visit www.yakima.com.au or www.yakima.co.nz to find your nearest store or contact us directly on 1800 143 548 (AU) or 0800 4776 722 (NZ).

Key Number:

YAKIMA

www.yakima.com.au
www.yakima.co.nz
www.yakima.com
www.yakima.eu

YAKIMA AUSTRALIA PTY LTD

17 Hinkler Court
Brendale, QLD 4500
Australia
1800 143 548

YAKIMA PRODUCTS, INC.

4101 Kruse Way
Lake Oswego, OR
97035-2541
USA
888 925 4621

ALL CONTENT SUBJECT TO YAKIMA AUSTRALIA PTY LTD COPYRIGHT © 2018